

United States Department of the Interior
National Park Service

National Register of Historic Places Registration Form

This form is for use in nominating or requesting determinations for individual properties and districts. See instructions in National Register Bulletin, *How to Complete the National Register of Historic Places Registration Form*. If any item does not apply to the property being documented, enter "N/A" for "not applicable." For functions, architectural classification, materials, and areas of significance, enter only categories and subcategories from the instructions. **Place additional certification comments, entries, and narrative items on continuation sheets if needed (NPS Form 10-900a).**

1. Name of Property

historic name Carroll City-Mount Olivet Cemetery

other names/site number _____

Name of Multiple Property Listing _____

(Enter "N/A" if property is not part of a multiple property listing)

2. Location

street & number South Grant Road not for publication

city or town Carroll vicinity

state Iowa county Carroll zip code 51401

3. State/Federal Agency Certification

As the designated authority under the National Historic Preservation Act, as amended,

I hereby certify that this x nomination request for determination of eligibility meets the documentation standards for registering properties in the National Register of Historic Places and meets the procedural and professional requirements set forth in 36 CFR Part 60.

In my opinion, the property x meets does not meet the National Register Criteria. I recommend that this property be considered significant at the following level(s) of significance: national statewide x local

Applicable National Register Criteria: x A B x C D

Signature of certifying official/Title: Deputy State Historic Preservation Officer _____ Date _____

State Historical Society of Iowa
State or Federal agency/bureau or Tribal Government

In my opinion, the property meets does not meet the National Register criteria.

Signature of commenting official _____ Date _____

Title _____ State or Federal agency/bureau or Tribal Government

4. National Park Service Certification

I hereby certify that this property is:

 entered in the National Register determined eligible for the National Register

 determined not eligible for the National Register removed from the National Register

 other (explain:) _____

Signature of the Keeper _____ Date of Action _____

Carroll City-Mount Olivet Cemetery
Name of Property

Carroll, Iowa
County and State

5. Classification

Ownership of Property
(Check as many boxes as apply.)

Category of Property
(Check only **one** box.)

Number of Resources within Property
(Do not include previously listed resources in the count.)

- private
- public - Local
- public - State
- public - Federal

- building(s)
- district
- site
- structure
- object

<u>Contributing</u>	<u>Noncontributing</u>	
3		buildings
3		site
6		structure
3	1	object
15	1	Total

Number of contributing resources previously listed in the National Register: N/A

6. Function or Use

Historic Functions

(Enter categories from instructions.)

FUNERARY/cemetery

FUNERARY/graves/burial

Current Functions

(Enter categories from instructions.)

FUNERARY/cemetery

FUNERARY/graves/burial

7. Description

Architectural Classification

(Enter categories from instructions.)

OTHER: Lawn-Park/Geometric

OTHER: Rustic/Naturalistic Park

Materials

(Enter categories from instructions.)

foundation: STONE

walls: STONE

METAL

roof: ASPHALT SHINGLES

other: _____

Carroll City-Mount Olivet Cemetery
Name of Property

Carroll, Iowa
County and State

Narrative Description

Summary Paragraph (Briefly describe the current, general characteristics of the property, such as its location, type, style, method of construction, setting, size, and significant features. Indicate whether the property has historic integrity.)

Carroll City-Mount Olivet Cemetery, a rural community burial ground, lies south of the railroad, which bisects the town, to the southeast of Carroll's courthouse and central business district, which are located north of the Chicago Northwestern-Union Pacific Railroad. Platted in 1872, the cemetery is west of the Old Fair Grounds Road (now South Grant Road). The present 41 acres of the rectangular cemetery are on a rolling elevation that is bordered on the north along East First Street, on the west behind residential neighborhoods along South Walnut Street and South Elm Street, on the east by the Kuemper High School athletic field and four homes along South Grant Road, and on the south by Clark Street and the Middle Raccoon River watershed. It remains on the original sites of the City and Catholic Cemeteries. Though the City of Carroll has developed to the north and west, the rural landscape across from the Catholic Cemetery still has farm fields and pastures to the east and southeast. Significant resources are its stone structures: two stone buildings, war monuments, a mausoleum, and amphitheater, as well as its wrought iron gates and fence. Each of the historic resources is in good repair, and all seven aspects of historic integrity are present. Over its 150 years, some alterations and additions to design elements, setting, materials, and workmanship have occurred, especially through the Works Progress Administration (WPA) construction projects during the 1930s, which is within the period of significance for this resource. Feeling and association are maintained through the rustic park-like cemetery's architectural details and varied uses from the late 19th century to the present.

Narrative Description (Describe the historic and current physical appearance and condition of the property. Describe contributing and noncontributing resources if applicable.)

(Iowa SHPO Additional Instructions: After the main **Narrative Description**, discuss any physical alterations since the period of significance under the subheading **Alterations**, and the seven aspects of integrity as it applies to the resource in a **Statement of Integrity** with each aspect discussed in its own paragraph.)

Sites contained within the boundaries of this historic district are the original ten-acre Carroll City Cemetery plat, the ten-acre 1933 Ries Addition between the City and Catholic Cemeteries, and the twelve-acre Mount Olivet Cemetery of the City of Carroll (the 1876 St. Joseph Catholic Cemetery, the 1886 Sts. Peter and Paul Catholic Cemetery, plus two acres in 1927) on the south end. (An additional 8.8 acres of reserve ground, added in 1972 and outside the historic district boundaries, complete the 41 acres of the cemetery.) In the original cemetery, north-south and east-west paved roads encircle and bisect the first four sections, and a circular road encloses the veterans' monuments with the grid layout of graves. The Ries Addition, designed by landscape architect Ray Floyd Wyrick and funded by the WPA, has winding roads that encircle irregularly-shaped sections. The Catholic cemeteries also have the grid pattern of north-south and east-west cement roads outlining and bisecting the two plots. The original physical layout of each site remains.

The historic era of the cemetery covers from the first recorded burial in 1873 to 1970, when the City and Catholic Cemeteries were united. Significant contributing resources of the original cemetery include the

Carroll City-Mount Olivet Cemetery

Carroll, Iowa

Name of Property

County and State

Anneberg Mausoleum, the Civil War Monument, the amphitheater and rostrum, and the (noncontributing) 1990s war monuments. The Ries Addition encompasses the (former) cemetery maintenance building/shelter house/chapel, the 1964 garage building, the restroom building, the American Legion Memorial, and the Baby Land exedra. Important structures include the First Street and South Grant Road gateways and the stone wall/wrought iron fence connecting them; these structures are additional Works Progress Administration projects. In the Catholic Cemeteries the Crucifixion statues and altar and the wrought iron fence and gates are contributing structures.

Many of the historic cemetery monument types typical in American cemeteries are represented in the Carroll City-Mount Olivet Cemetery. Reflecting the Egyptian Revival architecture in American cemeteries during the 19th century, obelisks, representing eternity, dominate Section 1 of the original Carroll City Cemetery. The 1927 Anneberg Mausoleum represents the Second Egyptian Revival - 1920s Art Deco Substyle, which was most appropriately applied to building projects associated with eternity and the afterlife. Lotus blossoms are etched in the vertical entrance and window supports, and winged orb/sun icons decorate the window lintels. Die, base, and cap granite and marble markers are common throughout, especially in the older sections. Pedestal grave markers are used throughout the older sections of the City and Catholic cemeteries. Some have inscriptions in German, reflecting the German heritage of the community. Pedestal markers in the Catholic Cemetery often have a cross on top; others have vaulted tops, or objects such as urns, books, or figures. Other types of markers present in this cemetery include chest tombs, cruciforms, round columns or pillars, bolsters on footings, four polished granite ledger slabs, and one ledger slab covered with tiles. Three above-ground crypts were built between 1953 and 2014. Large boulders with metal plaques mark three family plots in different sections of the cemetery. Two Catholic grave markers have plain concrete "kneelers" facing them. The few markers in the "potter's fields" are primarily simple, flat-to-the-ground stone markers. Most grave markers are of limestone, marble, and granite, with smooth and rough quarry-faced surface treatments.

Because of the prevalence of the Roman Catholic faith in Carroll, the Catholic Cemeteries of St. Joseph Parish (1876), Sts. Peter and Paul Parish (1886), (and later St. Lawrence Parish - after 1916) comprise one-third of the historic district. As in the city cemetery, a variety of gravestones exist in the Catholic cemetery. With the earliest death date of 1881, forty-two small white grave markers are in the southern part of the former Sts. Peter and Paul Cemetery for Franciscan Sisters of Perpetual Adoration who served in the Catholic institutions in Carroll.

Three plots mark the burial ground for local priests. Seven raised-top markers for Sts. Peter and Paul priests of the 20th century surround a cruciform memorial installed around 1975. The cross-shaped granite marker with a granite base on a concrete slab has the inscription "Thou art a priest forever." A second area at the intersection of roads in the western part of the Catholic Cemetery has large vertical white gravestones for three St. Joseph pastors of the early 20th century. A third area near the Crucifixion statues in the southwest part of the cemetery has ledger grave markers for four priests who served in Carroll.

Carroll City-Mount Olivet Cemetery

Carroll, Iowa

Name of Property

County and State

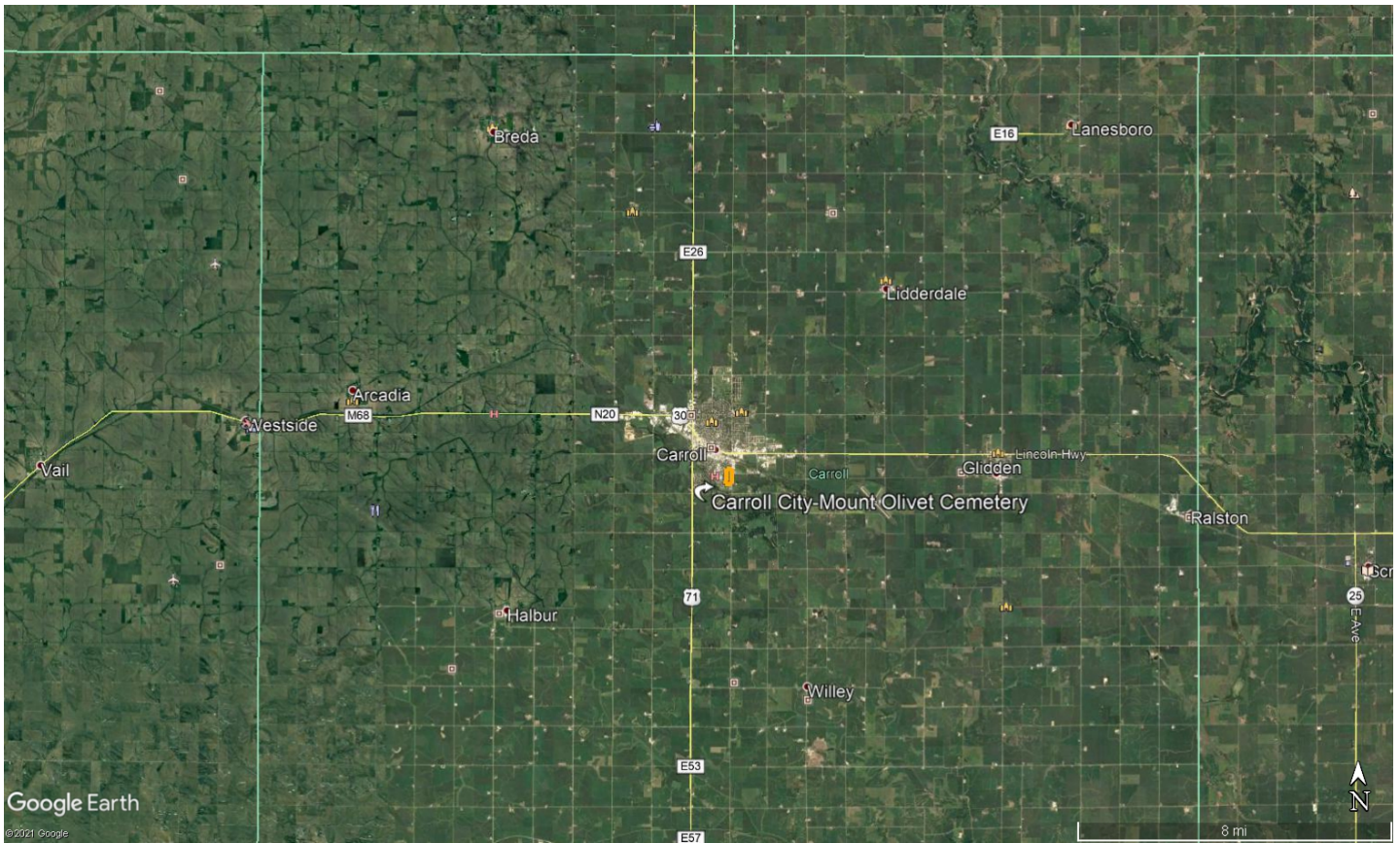

Figure 1: Regional Map showing the location of Carroll. The Carroll City-Mount Olivet Cemetery is outlined in orange. (Source: Google Earth, 2019.)
(Top of map is North)

Carroll City-Mount Olivet Cemetery

Carroll, Iowa

Name of Property

County and State



Figure 2: Carroll City-Mount Olivet Cemetery boundaries outlined in orange. (Source: Google Earth, 2019.)
(Top of map is North)

- Coordinates:**
- 1: 42.058681°, -94.861770°
 - 2: 42.058685°, -94.859329°
 - 3: 42.053201°, -94.859326°
 - 4: 42.053207°, -94.862535°
 - 5: 42.054207°, -94.862534°
 - 6: 42.054218°, -94.862061°
 - 7: 42.054418°, -94.862060°
 - 8: 42.054420°, -94.861742°

Carroll City-Mount Olivet Cemetery

Carroll, Iowa

Name of Property

County and State

Carroll City Cemetery
 -
 Mount Olivet Cemetery of the
 City of Carroll
 Site/Resources
 Map



C - contributing
 NC - noncontributing

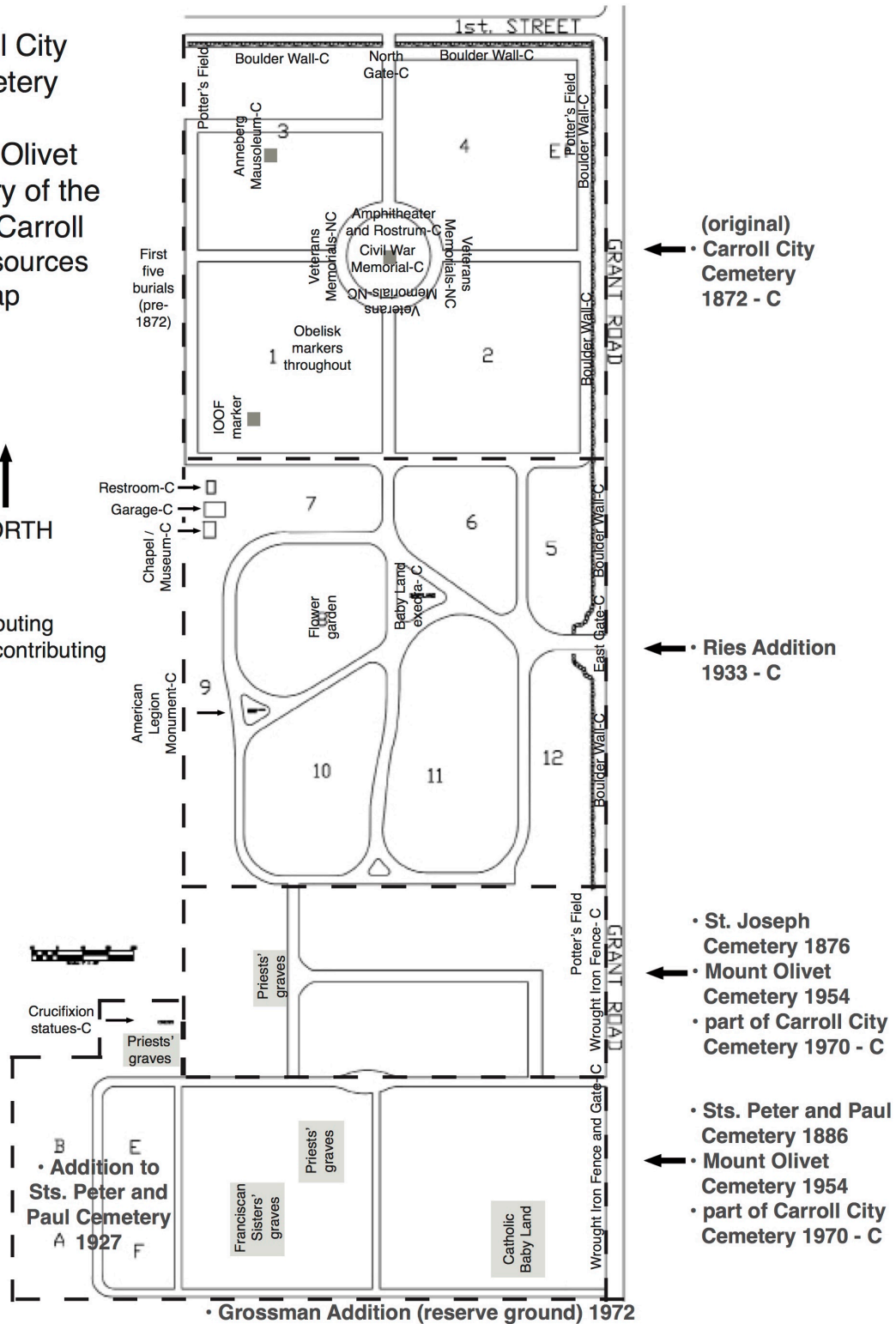

Figure 3: Base Map showing location of major buildings, structures, and objects within the Carroll City-Mount Olivet Cemetery from City of Carroll, prepared 1/4/2021



Carroll City-Mount Olivet Cemetery

Carroll, Iowa

Name of Property

County and State

DISTRICT INVENTORY



MAP ID	RESOURCE INFORMATION AND STATUS	DESCRIPTION AND HISTORY
1	<p>Anneberg Mausoleum Location: Original City Cemetery, Section 3 Date of Construction: 1927 Status: Contributing Structure Architect/Builder: Local masons</p>  <p>Figure 4 – Mausoleum from east - Sept. 12, 2017</p>	<p>Description: The single free-standing, walk-in mausoleum is 12’ by 12’ at the base, tapering slightly to a rock roof. The red metal double door centered on the east side is 77” high by 42” wide. Inset red metal window coverings on the north and south sides are 3’ high by 2’ wide. The doors and windows are bordered by 16” wide granite panels. The mausoleum represents the Second Egyptian Revival - 1920s Art Deco Substyle. Lotus blossoms are etched in the vertical entrance and window supports, and winged orb/sun icons decorate the window lintels. Inside the granite panels on either side of the door are engraved the names and dates of Anneberg family members who are interred there.</p> <p>History: Dr. A. R. Anneberg (1881-1946), a prominent local physician, had the stone vestibule mausoleum erected for Bertha Kivits Anneberg, his first wife (also later for his parents and himself). To construct the Anneberg Mausoleum, graves and lots 49-60 were relocated from the middle of Section 3 to the north edge along the wall so building materials could be brought in on a new road constructed for that purpose.</p>
2	<p>Amphitheater with Rostrum Location: Original City Cemetery/Memorial Circle Date of Construction: 1935 Status: Contributing Structure Architect/Builder: Works Progress Administration</p>  <p>Figure 5 – Amphitheater and rostrum from southwest – Aug. 27, 2020</p>	<p>Description: The wall of the 39-foot-long semicircular stone amphitheater with a stone floor is 49” high and 20” wide. Stone steps lead to the amphitheater from the east and west. At the open side of the amphitheater, the stone rostrum faces south, toward the Civil War Monument. The rostrum top slants from 45” to 49” high and is 39” wide. Its stone base is 7” high, and it is 49” wide by 25.5” deep.</p> <p>History: Since 1936 this has been primarily used for Memorial Day ceremonies. In 1994 a granite plaque was mounted on the north side of the amphitheater that identifies “Memorial Circle/Maurice Dunn Post 7/Ralph Neppel Post 2642/Lest We Forget/1994” with engraved symbols for the American Legion, American Legion Auxiliary, Veterans of Foreign Wars, and VFW Ladies Auxiliary.</p>
3	<p>Civil War Monument</p>	<p>Description: Standing 21 feet high, the 85-ton monument is</p>

Carroll City-Mount Olivet Cemetery

Carroll, Iowa

Name of Property

County and State

	<p>Location: Original City Cemetery/Memorial Circle Date of Construction: 1935-1936 Status: Contributing Object Architect/Builder: Works Progress Administration</p>  <p>Figure 6 – Civil War Monument from northeast – Aug. 27, 2020</p>	<p>an obelisk of native stones. The base is in two sections, the lower section measuring 10’ square and one foot thick, and the second section 8’ square and one foot thick. The base of the monument proper is 6’ square, tapering to 3’ square at the top and converging to a point. Granite slabs bearing the names of the former Jeff Davis GAR Post members are placed on each side of the monument about 5’ from the base. The slabs are 3’ 9” in height; and 2’ 6” wide at the bottom, tapering to 2’ wide at the top.</p> <p>History: In March 1935 WPA relief workers erected the monument to replace the old GAR monument. The four plaques with the names of 68 Carroll persons who fought in the Civil War were dedicated on Memorial Day, May 30, 1936. A box containing pictures, clippings, and records was sealed in the monument.</p>
<p>4</p>	<p>North Gateway and Fence Location: Original City Cemetery/East First Street Date of Construction: 1937 Status: Contributing Structure Architect/Builder: Works Progress Administration</p>  <p>Figure 7 – North gateway from south – Aug. 24, 2020</p>  <p>Figure 8 – North fence from southwest – Aug. 24, 2020</p>	<p>Description: The north wall, one-third of the 1,400 feet of wall and 89 pillars, is made of native field stones, masonry, and wrought iron. The double gates and upper part of the fence are composed of spear-tipped wrought iron and painted black.</p> <p>History: In April 1873 the first cemetery fence around the original cemetery was a 4-board and cap fence. In 1894 that wooden fence was replaced with a woven wire fence. In 1911 the Carroll Cemetery Association erected an iron fence along the north side to replace the 1894 fence. The iron fence and a large double gate included an arch above the driveway gate and the pedestrian gate, over which were the words, “Our Silent City.” After the boulder wall was constructed along the east boundary of the Ries Addition, the stone and iron fence was duplicated along the north boundary also, completing the WPA project in 1937.</p>
<p>5</p>	<p>Shelter House/Chapel/Maintenance Building Location: Ries Addition Date of Construction: 1935</p>	<p>Description: The 25’ x 19’ stone building has a brown-shingled gable roof that was installed in 1995, built over the base of the original 1935 roof, preserving its original stone border inside the structure. The east side of the building has</p>

Carroll City-Mount Olivet Cemetery

Carroll, Iowa

Name of Property

County and State

Status: Contributing Building
Architect/Builder: IERA; Harry Badley, City Engineer; Lawrence Schwenk, mason



Figure 9 – Cemetery shelter house/chapel from southeast – May 7, 2018



Figure 10 – Cemetery shelter house from southwest – May 25, 2018

two nine-pane, black metal-framed windows on either side of a white, wooden paneled door with a timed lock. The north and south sides each have a nine-pane, black metal-framed window. The west side has two six-pane, black metal-framed windows and a wooden blue and gray double carriage door.

History: In 1935 IERA workmen constructed the stone building on the west edge of the City Cemetery. It was planned to contain two rooms: one as a garage and tool room; the other to be equipped with a fireplace and furnished as a chapel for funeral services in inclement weather, neither of which was completed. It was used as the cemetery office and maintenance storage building. In 2017 the CHPC modified the building into the Carroll Cemetery Museum, replacing the overhead metal garage door on the west side with wooden carriage doors, and the metal east door with a paneled wood door, similar to the 1935 doors.

In 1927 the city council appointed Harry W. Badley as city engineer to fill a vacancy in the position. In 1931 he made a new ground plat of the city of Carroll. In 1935 he prepared plans for a pump house for the new city well. In 1934 Badley was reappointed city engineer. Lawrence Schwenk was a mason who did cement work in Templeton, Gray, and Carroll, Iowa.

6

Restroom
Location: Ries Addition
Date of Construction: 1939-1940
Status: Contributing Building
Architect/Builder: Works Progress Administration



Figure 11 – Restroom building from south – Sept. 2020

Description: This stone building (13' x 20.5') with an asphalt-shingled gable roof has a single restroom in the south half and storage shelves in the north half. Each half has a door with a wooden overhang; the south door is metal (78" H x 30" W); the north door is wood (80" H x 35" W). Two inset windows (29.5" H x 25.5" W) on the east and west sides are boarded over.



History: In 1939-1940 this one-story restroom building was constructed north of the 1935 shelter house/chapel/maintenance building. It is used as a restroom for cemetery workers and walkers and a storage facility.

Carroll City-Mount Olivet Cemetery

Carroll, Iowa

Name of Property

County and State

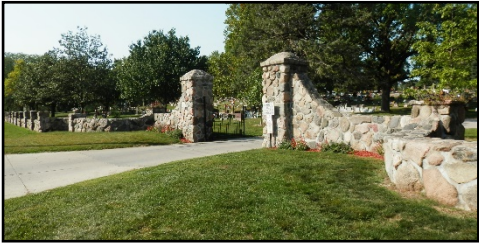

	 <p>Figure 12 – Restroom building from west – Sept. 2020</p>	
<p>7</p>	<p>Garage Location: Ries Addition Date of Construction: 1964 NRHP Status: Contributing Building Architect/Builder: Badding Construction Company</p>  <p>Figure 13 – Garage from west – Aug. 24, 2020</p>	<p>Description: The light tan brick-veneered building has a white wood garage door on the west side. The south side has a white metal door and a twelve-pane, black metal-framed window. The east side has a six-pane, black metal-framed window. The north side is a solid brick wall, and the gable roof has asphalt shingles.</p> <p>History: Between the Cemetery Museum to the south and the restroom building to the north, the garage was used as an office and storage facility for mowers and tools until 2017 when the new maintenance building was constructed. Now the garage stores the bonnets (steel frames used to thaw frozen grave plots in the winter) and the lawn care equipment.</p>
<p>8</p>	<p>East Gateway and Fence Location: Ries Addition and Original City Cemetery Date of Construction: 1936 Status: Contributing Structure Architect/Builder: Works Progress Administration</p>  <p>Figure 14 – East Gateway and fence from northeast – Aug. 24, 2020</p>	<p>Description: This monumental gateway--eighty feet broad, with pillars ten feet high, is made of stones from the countryside of Carroll County. In 1936, at the same time as the new east gateway, a boulder wall of native field stones, masonry, and wrought iron was constructed along the east boundary of the Addition. Accounting for two-thirds of the cemetery's stone and iron fence, this fence and gate, along with the north entryway gate and fence, completed the 1,400 feet of wall and 89 pillars in 1937. The gates and upper part of the WPA fence are made of spear-tipped wrought iron and painted black.</p> <p>History: In July 1927 city engineers erected new ornamental fencing on the east side of the city cemetery, similar to that which was on the north side. The old east side fence was put up on the west side. The new fence, which cost \$500, was made possible by the \$1,000 bequest left by the late H. E. Russell for the beautification of the cemetery. In 1936 the Works Progress Administration constructed the east gateway on the South Grant Road side of the 1933 Ries Addition. This entrance now serves as the main formal entry to the cemetery. Also in 1936 a handsome boulder wall of native field stones, masonry, and wrought iron was constructed</p>

Carroll City-Mount Olivet Cemetery

Carroll, Iowa

Name of Property

County and State



<p>9</p>	<p>Baby Land Exedra Location: Ries Addition Date of Construction: C 1935 Status: Contributing Structure Architect/Builder: Works Progress Administration</p>  <p>Figure 15 – Baby Land exedra from east – Sept. 4, 2020</p>	<p>along the east boundary of the Addition.</p> <p>Description: With 18” thick walls, the structure is 8’ deep and 10’ wide and has a stone floor. At one time the structure had a gable roof on two posts; but due to deterioration, this was removed in 1999.</p> <p>History: In the heart-shaped Baby Land in Section 8 of the 1933 Ries Addition, a small stone exedra, a semicircular landscape structure, provides a place for cemetery visitors to sit on the wooden benches inside.</p>
<p>10</p>	<p>American Legion Memorial Location: Ries Addition Date of Construction: 1937-1938 Status: Contributing Object Architect/Builder: Works Progress Administration</p>  <p>Figure 16 – American Legion Monument from east – Aug. 30, 2020</p> 	<p>Description: About 16’ high, the native stone and concrete monument is 6 1/2’ by 3 1/2’ at the base, gradually diminishing in size until at the top it is 3’ wide. Designs commemorative of the First World War are on the four sides. A short retaining wall of native stone is constructed around the monument’s plot. The monument is located at the west side and approximately in the center north and south of the Ries Addition on a triangular piece of ground.</p> <p>History: With the work and some material furnished under a WPA project, the Maurice Dunn Post #7 of the American Legion and the City of Carroll shared the cost of the construction of this monument to the memory of the community’s World War veterans. The monument is patterned somewhat after the Cenotaph World War Memorial in London. Included in the structure is a specially constructed box in which information pertaining to the veterans and construction of the monument was placed.</p>

Carroll City-Mount Olivet Cemetery

Carroll, Iowa

Name of Property

County and State

	<p>Figure 17 – American Legion Monument from west – Aug. 27, 2020</p>	
<p>11</p>	<p>Catholic Cemetery Fence and Gates Location: Mount Olivet Cemetery Date of Construction: early 1960s Status: Contributing Structure Architect/Builder: unknown</p>  <p>Figure 18 – Catholic cemetery fence from south – Aug. 27, 2020</p>  <p>Figure 19 – Catholic cemetery gate from west – Aug. 27, 2020</p>	<p>Description: Consisting of 80 seven-foot sections with four-sided spire wing tip finials, the iron fence is divided by an entry with two wrought iron gates, each 12’ wide by 46” high. On either side of these gates is a 14’ curved section of fence with two 24” square stone pillars 63” tall at each end of the curved piece. The wrought iron fence borders the Catholic Cemetery from the City Cemetery’s stone wall to the south edge of the cemetery grounds along South Grant Road.</p> <p>History: In 1925 a new fence was built along the east side of the area. Around 1940 the city hauled in some rock to complete the cemetery fence along the Catholic cemetery, but it was never finished with a stone structure. In the early 1960s this fence replaced a wire fence with wooden posts. On the west side of the cemetery a chain link fence replaced a welded wire and wooden post field fence in the 1950s.</p>
<p>12</p>	<p>Crucifixion Statues on Altar Location: Mount Olivet Cemetery Date of Construction: early 1900s NRHP Status: Contributing Object Architect/Builder: Boyce Monumental Sales</p>	<p>Description: The Crucifixion Group has 3/4 life-sized statues of Blessed Mother Mary; John, the Apostle; and a crucified Christ. Set on a concrete pad, the polished marble altar base of the statues group is 48” high by 90” wide by 39” deep, with an engraved wreath on the front. The marble crucifix is ten feet tall.</p> <p>History: The statues and altar were originally installed at an intersection in the middle of the Catholic cemeteries. Memorial Day Field Masses were celebrated at this altar area from 1949 to 1961. In June 1959, the Catholic Cemetery Association discussed replacing the Crucifixion Group with provision for a permanent altar. In the early 1960s Boyce Monumental Sales moved and reinstalled the statues group with a new marble crucifix, corpus, and altar on a hill in the southwest part of the cemetery in the 1927 two-acre addition.</p>

Carroll City-Mount Olivet Cemetery

Carroll, Iowa

Name of Property

County and State



Figure 20 – Crucifixion group statues and altar from south – Aug. 27, 2020

13

Veterans War Memorials

Location: Original City Cemetery/Memorial Circle

Date of Construction: 1990-1991

Status: Noncontributing Object

Architect/Builder: Larry Boyce and local volunteers



Figure 21 – POW-MIA Memorial from south Aug. 27, 2020



Figure 22 – Veterans War Memorials walkway

Description: Seven memorials honoring veterans stand in a half circle around the Civil War Monument. Each monument is 7’ high, 8’ wide, and 1’ deep. Engraved plaques centered on each war memorial are polished gray granite slabs (48” H x 42” W) mounted on walls of native stone. The Prisoner of War-Missing in Action memorial is similar, only the granite is black. Nearly 30 tons of native rock went into the project.

History: With the project in the planning stage for about three years, American Legion, Maurice Dunn Post #7; the Veterans of Foreign Wars, Post 2642; the business community, and private donors contributed to the memorials. Salvaged from the demolished Carroll Theatre, the granite was donated by Quandt Auto Salvage and Boyce Monumental Sales. Larry Boyce sandblasted the imagery on each monument, and Paul “Smiley” Walz of Carroll supervised the construction. On May 28, 1990, five of the monuments were dedicated to recognize veterans of World War I, World War II, the Korean War, the Vietnam War, and POW-MIA personnel. On May 27, 1991, monuments for the Spanish-American War and the Persian Gulf War were dedicated. The project’s materials and labor cost more than \$100,000. Thirty veterans and other city residents put in more than 2,000 volunteer man-hours on the project.

Carroll City-Mount Olivet Cemetery

Carroll, Iowa

Name of Property

County and State

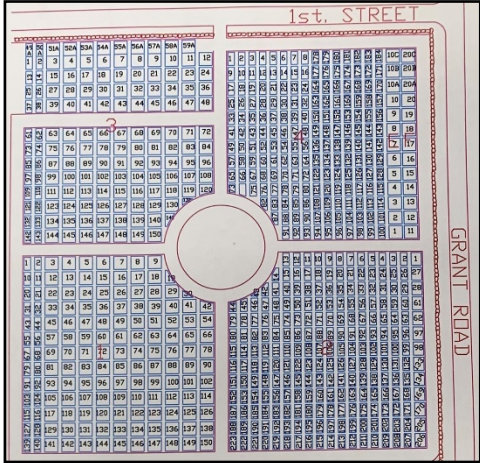
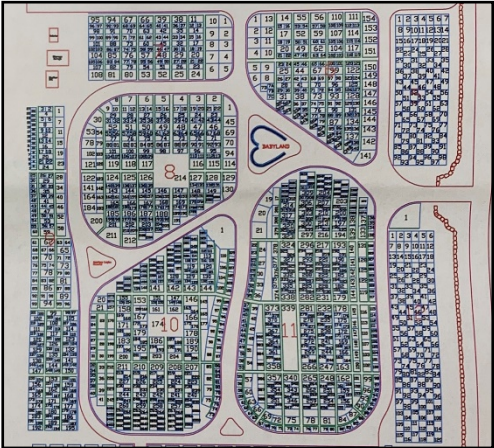
from north - Aug. 27, 2020		
14	<p>Original City Cemetery Location: East First Street and South Grant Road Date of Construction: circa 1873 Status: Contributing Site Architect/Builder: William S. Winnett, A. Bruch, County Surveyors</p>  <p style="text-align: center;">Figure 23 - Original City Cemetery site. Map from Carroll City Cemetery 2020 (Top of map is North)</p>	<p>Description: Ten acres of cemetery ground on the north end of the district with axial/bilateral symmetry was originally laid out in four equal sections divided by roads. The middle of the site includes the Memorial Circle with war monuments from the Civil War to the 20th century.</p> <p>History: The Carroll Town Council first proposed a cemetery in 1870. In 1872 William S. Winnett, county surveyor, platted Sections 1 and 2. In 1885 county surveyor A. Bruch platted Sections 3 and 4 north of the first two. In 1927, lots 49-60 were moved to the north edge of Section 3 so building materials could be moved in on a new road to build the Anneberg Mausoleum in that section.</p>
15	<p>Ries Addition Location: South Grant Road Date of Construction: 1934-1941 Status: Contributing Site Architect/Builder: Ray Floyd Wyrick, Landscape Architect; WPA</p>  <p style="text-align: center;">Figure 24 - Ries Addition Cemetery site. Map from Carroll City Cemetery 2020 (Top of map is North)</p>	<p>Description: The ten acres of cemetery ground between the original cemetery and the Catholic cemeteries has an early 20th century Rustic/Naturalistic Park design in eight irregular sections encircled by winding roads. The Addition contains the (former) cemetery maintenance building, restroom building, 1964 garage, the Baby Land exedra, and the American Legion Monument. A rock wall and iron gates are on the east side.</p> <p>History: Adam Ries originally owned the ten acres as a garden/orchard. The City bought the land in 1933 to expand the City Cemetery. Under the landscaping direction of Ray Floyd Wyrick, from 1934-1941 the Works Progress Administration relief workers developed the land and built the structures, which remain today.</p>
16	<p>Mount Olivet Cemetery</p>	<p>Description: Twelve acres of cemetery ground directly south</p>

Carroll City-Mount Olivet Cemetery

Carroll, Iowa

Name of Property

County and State

Location: South Grant Road
Date of Construction: 1876, 1886, 1927
Status: Contributing Site
Architect/Builder: Lafayette McCurdy, county surveyor; I. W. Hoffmann

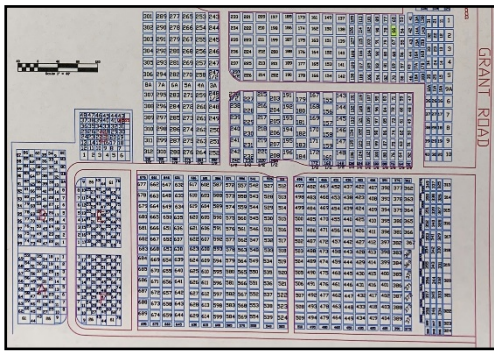

Figure 25 – Mount Olivet Cemetery site.
Map from Carroll City Cemetery 2020
(Top of map is North)

of the Ries Addition are the site of Mount Olivet Cemetery. The graves are laid out in a grid pattern bisected by north-south and east-west roads. An entrance along South Grant Road leads to a wider area in the road where the Crucifixion statues and altar were originally located.

History: St. Joseph Catholic Parish began its cemetery in the north half of this site in 1876. Ten years later Sts. Peter and Paul Catholic Parish began its cemetery south of the St. Joseph Cemetery. In 1927 Sts. Peter and Paul Parish purchased an additional two acres to expand to the west. In 1954 the two Catholic cemeteries were united under the name Mount Olivet Cemetery. In 1970 the City of Carroll assumed ownership and its name became Mount Olivet Cemetery of the City of Carroll.

ALTERATIONS

Few physical alterations have taken place at the cemetery since 1970. Due to deterioration, the gable roof on poles over the Baby Land exedra in the Ries Addition was removed in 1999. In 1990-1991 the seven memorials honoring veterans were added to the Memorial Circle. In 1994 the sidewalk near the memorials was expanded, a new flagpole was installed, and a granite plaque on a stone mounted on the amphitheater's north side identifies the Memorial Circle's sponsors with engraved symbols for the American Legion, American Legion Auxiliary, Veterans of Foreign Wars, and VFW Ladies Auxiliary. In 2017 the Carroll Historic Preservation Commission (CHPC) modified the 1935 maintenance/shelter house/chapel building into the Carroll Cemetery Museum. The current brown asphalt-shingled gable roof replaced the original slate roof in 1995. This new roof was built over the base of the original roof, preserving its stone border inside the structure. With the help of Sexton John Snyder and the cemetery workers, inside the building they replaced and puttied six multi-paned windows with clear glass panes; cleaned the floor, walls, and rafters; capped pipes; and removed burners and equipment. Outside, the workers removed propane tanks and fencing, moved broken gravestones, did groundwork and soil enhancement, and added a downspout to the southeast corner. They replaced the modern overhead metal garage door on the west side with wooden carriage doors, similar to the original doors. City workers replaced the sidewalk on the east side to make it ADA compliant. In Spring 2018 the CHPC painted window frames inside and out and replaced the metal east door with a paneled wood door similar to the 1935 door. Outside they landscaped the north, east, and south sides of the building with perennials and low maintenance bushes and installed a donated concrete bench on a concrete pad outside the east door to replace the old wooden bench.

Carroll City-Mount Olivet Cemetery

Carroll, Iowa

Name of Property

County and State

STATEMENT OF INTEGRITY -

The Carroll City-Mount Olivet Cemetery retains solid qualities for all seven aspects of integrity:

LOCATION -

The cemetery retains excellent integrity of location because it encompasses the original 1873 location of the Carroll City Cemetery and the 1876 and 1886 Catholic cemeteries, the 1927 two-acre addition to the Sts. Peter and Paul Cemetery, as well as the 1933 ten-acre Ries Addition in the middle.

DESIGN -

The cemetery retains excellent integrity of design. The original cemetery's late 19th century classical, axial organization and bilateral symmetry enhance the north end of the cemetery; Ray Floyd Wyrick's early 20th century Rustic/Naturalistic Park landscape design combined with the rustic park architecture dominate the center; and the two Catholic cemeteries to the south retain their grid-patterned, open park-like landscape design as platted by Lafayette McCurdy in the 1870s and again by I. W. Hoffmann in 1918. Wyrick's plan to link the City Cemetery and the newly acquired Ries ground into one cemetery and make provision for joining the Catholic and City cemeteries has also been accomplished. In 1935 Sexton Will Light originally conceived the shelter house/chapel, and his efforts brought the plan to a reality. Carroll City Engineer Harry Badley designed the structure.

SETTING -

The cemetery retains excellent integrity of setting. Other than the loss, replacement, and addition of some trees and changes in plantings throughout the years, the setting remains intact. Well-tended lawns and flower beds complement the cemetery walls, gates, and monuments, which remain in their original locations. Situated on the highest elevation in the neighborhood, the cemetery's blended landscape designs feature mature shade and evergreen trees, gently rolling terrain, several benches, and curving driveways. Liberal application of regulations about grave decorations allows people to decorate graves with statues, solar lights, plants, and seasonal floral arrangements throughout the year.

MATERIALS -

The cemetery retains very good integrity of materials because the gravestones, monuments, mausoleum, amphitheater, rostrum, walls, buildings, and objects are the original materials, except for the reroofing of the maintenance/shelter house/chapel and its new carriage doors and east door, which replicate the original doors; and the stone wall and wrought iron gates replacing the earlier wood and wire fences and iron north gate. Field stone from the surrounding area is the main component of the shelter house/museum, restroom, boulder walls, war memorials, amphitheater, and exedra. This natural material is in harmony with the cemetery's environment. The Catholic cemeteries' field fence has been replaced with a wrought iron fence, and the Crucifixion statues have a new corpus, crucifix, and marble altar.

Carroll City-Mount Olivet Cemetery

Carroll, Iowa

Name of Property

County and State

WORKMANSHIP -

The cemetery retains very good integrity of workmanship because the handcrafted architectural details of the buildings, objects, and structures are well preserved. The gravestones, monuments, mausoleum, stone walls, and gateways all survive even though repairs and improvements have been needed through the years. The skills of local masons using rocks from farm fields are also present in the stonework in the mausoleum, the war monuments, the amphitheater and rostrum, the walls, the gateway structures, the restroom building, and the Cemetery Museum. WPA workers used hand tools to reshape the topography of the original cemetery. To modernize the old parts of the Carroll cemetery, a large WPA gang went over the whole ground, took up the old sod, leveled down the raised lots and filled the alleys, then replaced the sod ("Carroll Cemetery Project"). Mason Lawrence Schwenk's artistic, rustic pioneer building techniques using stone and concrete contributed a great deal to the durability and beauty of the shelter house/chapel building, now the Cemetery Museum.

FEELING -

The cemetery retains excellent integrity of feeling because it evokes a sense of time and place as a rural community burial ground. Visitors can still experience the cemetery much as it was in the 19th and 20th centuries, with daily visitors coming to pay respects at gravesites; and its winding roads are a favorite place for people to walk and exercise their dogs. The peaceful natural environment within its walls provides a sanctuary for meditation and reflection. Carroll citizens have always maintained an involvement in and sense of ownership in the cemetery grounds. Besides the cemetery employees, individuals and community organizations care about and assist in the maintenance of the cemetery.

ASSOCIATION -

The cemetery retains excellent integrity of association because as the Carroll City-Mount Olivet Cemetery of the City of Carroll, it remains an active burial ground and gathering space to the present day. Citizens consistently support its patriotic uses and preservation. Civic pride is evident in the cemetery's ceremonial uses beyond burials. Since the 1880s veterans' groups have sponsored Memorial Day services at the City Cemetery and decorated graves with American flags. In 2005 caring citizens raised \$15,000 for needed boulder wall repairs. The present Carroll City Cemetery has had a non-Catholic and a Catholic identity. In 1970 the Catholic and Carroll City Cemeteries were united, as they remain today. Generations of citizens have visited and been visited in its boundaries. The cemetery has retained its permanence and significance for 150 years.

Carroll City-Mount Olivet Cemetery
Name of Property

Carroll, Iowa
County and State

8. Statement of Significance

Applicable National Register Criteria

(Mark "x" in one or more boxes for the criteria qualifying the property for National Register listing.)

- A Property is associated with events that have made a significant contribution to the broad patterns of our history.
- B Property is associated with the lives of persons significant in our past.
- C Property embodies the distinctive characteristics of a type, period, or method of construction or represents the work of a master, or possesses high artistic values, or represents a significant and distinguishable entity whose components lack individual distinction.
- D Property has yielded, or is likely to yield, information important in prehistory or history.

Criteria Considerations

(Mark "x" in all the boxes that apply.)

Property is:

- A Owned by a religious institution or used for religious purposes.
- B removed from its original location.
- C a birthplace or grave.
- D a cemetery.
- E a reconstructed building, object, or structure.
- F a commemorative property.
- G less than 50 years old or achieving significance within the past 50 years.

Areas of Significance

(Enter categories from instructions.)

SOCIAL HISTORY
LANDSCAPE ARCHITECTURE
ARCHITECTURE

Period of Significance

1873 – 1970

Significant Dates

1873
1876
1886
1941
1970

Significant Person

(Complete only if Criterion B is marked above.)

Cultural Affiliation (if applicable)

Architect/Builder

Wyrick, Ray Floyd
Schwenk, Lawrence
McCurdy, Lafayette
Hoffmann, I. W.
Bruch, A.
Winnett, William S

Carroll City-Mount Olivet Cemetery

Carroll, Iowa

Name of Property

County and State

Statement of Significance

Statement of Significance Summary Paragraph (Provide a summary paragraph that includes level of significance, applicable criteria, justification for the period of significance, and any applicable criteria considerations).

The Carroll City-Mount Olivet Cemetery is locally significant and eligible for the National Register under Criterion A: Social History and Criterion C: Architecture and Landscape Architecture. Under Criterion A, it is significant as a representation of the social history of settlers, particularly Germans and Irish, from the East Coast to western Iowa after the Civil War as well as the community at large. Under Criterion C, the cemetery is significant for its landscape architecture, particularly the 1933 Ries Addition, designed by noted landscape architect Ray Floyd Wyrick in the mid-to-late 1930s; for the architectural design of the cemetery's buildings, monuments, gates, and boulder walls during the 1930s; and for the cemetery project's being funded by the Works Progress Administration (WPA). The overall cemetery landscape reflects the influence of national movements and trends in cemetery landscape design which overlapped during the 19th into the 20th centuries. The period of significance begins in 1873, with the first known burial in the newly-established cemetery, and ends in 1970, when the City and Catholic cemeteries were united into one entity. Significant dates include 1873, 1876 (establishment of St. Joseph Catholic Parish cemetery), 1886 (establishment of Sts. Peter and Paul Catholic Cemetery), 1933-1941 (Ries Addition purchased and developed), and 1970 (when the City and Catholic cemeteries were united into one entity).

The Carroll City-Mount Olivet Cemetery meets Criterion Consideration D because it derives its primary significance from its age, distinctive design features, and association with the various cemetery design movements of the late nineteenth and early twentieth centuries.

Narrative Statement of Significance

(Provide at least one paragraph for each area of significance.)

(Iowa SHPO Additional Instructions: For properties not nominated under Criterion D, include a statement about whether any archaeological remains within or beyond the footprint of the property were assessed as part of this nomination under the subheading **Archaeological Assessment**.)

CRITERION A: Social History

The Carroll City-Mount Olivet Cemetery is eligible for its local significance under Criterion A because it is associated with the social history of settlers, predominantly Germans, who migrated from the East Coast to the Midwest after the Civil War. The German immigrations of the 1860s and late 1880s, and the growth of towns through the initiative and hard work of these early citizens, are the story of America and of Carroll itself. The growth and development of Carroll and its cemetery are the result of these Germans, along with others from Ireland and northern and western Europe. These new citizens living their values created the social history of Carroll and the Carroll City-Mount Olivet Cemetery. In 2021 descendants of these early settlers remain the major ethnic groups (Germans - 37.59% and Irish - 8.83%) in Carroll (*Carroll, Iowa*). The burial customs of the past and romantic appreciation of nature are visible and honored in Carroll's historic community cemetery. As they once created a vibrant, living community, they also still share this community of the dead.

The area chosen for the site of the burying ground, just over one mile southeast of the courthouse square, was

Carroll City-Mount Olivet Cemetery

Carroll, Iowa

Name of Property

County and State

rolling land on the highest point above the flood plain of the Middle Raccoon River. Lower areas in and around Carroll were known to be swampland. Because the town and cemetery area were open prairie in the beginning, many trees and plantings had to be installed in all three sites to create the pleasant, park-like environment of today. Much as the cemetery was in the 19th and 20th centuries, visitors still experience it every day by coming to pay their respects at grave sites; and its winding roads shaded by large trees are favorite places for people to walk and exercise their dogs. Carroll and its cemetery have grown older together. Their shared history reflects the values of the early settlers and their contemporary descendants. Because of this interconnected social history for over 150 years, the Carroll City-Mount Olivet Cemetery is eligible for its local significance under Criterion A.

This cemetery reflects the history of the Carroll community. Multigenerational burials relate to ethnicity, religious affiliation, and socioeconomic conditions and how these developed in Carroll. The Carroll Cemetery did not restrict who could be buried here, but in some sections certain features of religion, economic class, and the treatment of infant burials are notable elements. The clustering of burials by religious preference and ethnicity is more prevalent than by social standing. This is due to the fact that St. Joseph Parish (aka “the Irish parish”) Cemetery and Sts. Peter and Paul Parish (aka “the German parish”) Cemetery were established as Roman Catholic burying grounds. The Franciscan Sisters’ plot, parish priests’ plots, and Catholic Baby Land are specific areas within these grounds.

Two “potter’s fields,” areas dedicated for burials of homeless, unidentified, and indigent persons are along the northwest edge of Section 3 and the northeast side of Section 4 near the fence line of the original Carroll City Cemetery; a third area is along the east fence line in St. Joseph Cemetery. Few tombstones mark the paupers’ graves.

Although many infants were historically buried in their respective family plots, the Carroll City-Mount Olivet Cemetery has two “infant cemeteries,” or Baby Lands. One is in the heart-shaped area designated by architect Wyrick in the 1933 Ries Addition. The other dedicated infant burial section contains over 170 graves in four north-south rows at the south end of the Catholic Cemetery.

Residents

In 1861, even before the European immigrants joined the westward movement across Iowa to settle in Carroll, the Sioux and Pottawattamie peoples used the lands around the present-day cemetery grounds as part of their trail from Indian town in Cass County through Carroll County to Big Grove in Sac County. William Gilley, one of the founders of Carroll, remembered that the trail “passed to the northwest of the fair grounds [east of the cemetery], struck the hill about where Adam Ries has his garden and vineyard [the 1933 Ries Addition to the cemetery]. Thence it went over the hill through the present site of the cemetery ground [the original Carroll City Cemetery plot]” (“More Reminiscences” [sic]).

German immigration began slowly in the mid- to late-1860s, but their numbers and influence grew in intensity

Carroll City-Mount Olivet Cemetery

Carroll, Iowa

Name of Property

County and State

and volume. According to 1875 census figures, Carroll had a population of 812 (comprising 158 families): “The American-born population was listed as 670, while the foreign-born population, mainly Germans, numbered 142. This latter figure doubtless understates the significance of the foreign element by not including many of their children who were born in America—another 154 Carroll residents reported having both parents born outside the United States, and 21 others had at least one parent of foreign birth” (Reineke Chapter 3). By 1885, Germans comprised almost 10,000 of Carroll County’s 16,329 citizens (Reineke Chapter 3). “By the end of the [19th] century, . . . Outside of Scott County, Carroll County would have the highest number of German Americans” (Schwieder 96).

German ethnicity is evident in the cemetery in the many tombstones with German inscriptions, epitaphs, prayers, familial relationships, and birth locations. Although some are in the City Cemetery, the majority of these tombstones are in the Catholic cemeteries.

Large families were important to settlers, necessary for survival on the open prairie land to operate farms. The high infant mortality required a burial ground early in the town’s history. In the 1860s several bodies, mostly children (Charlie Baird 1861-1862, Mary Beall 1857-1863, Hattie B. Macomber unknown-1861, Edwin J. Macomber 1863-1868, Nellie Hillman 1858-1861, Nettie J. Hillman 1868-1868), were buried just west of the original city cemetery plat. They were later reinterred alongside their families within the platted cemetery. Their names and dates are inscribed on large family grave markers in Section 1. Many of these family markers have multiple names and/or several smaller stones for individuals nearby. If not interred in family plots, infants’ and children’s graves have been located around the exedra in the Ries Addition’s Baby Land. Over 170 graves in four rows comprise the Catholic Baby Land at the south end of the former Sts. Peter and Paul Cemetery.

Religious Groups

The Presbyterians (1870), Methodist Episcopalians (1868), and Congregationalists (1873) all erected churches early in Carroll’s history, but the vast majority of the German (and Irish) immigrants to Carroll County were Roman Catholics. Prior to 1874, however, there was no Catholic church in Carroll City (as it was called until 1875), and those wishing to attend services had to travel to Mt. Carmel, seven miles northwest. Catholics in Carroll soon developed their congregations and two cemeteries. By the 20th century they had become the largest denomination in the city with three parishes.

In 1876, within two years of St. Joseph Parish being established in Carroll, parishioners purchased land south of the City Cemetery and west of the Old Fair Grounds Road to create a cemetery dedicated to and incorporated by the name Catholic Cemetery of Carroll, for all Catholics of Carroll. Lafayette McCurdy, who had served as county treasurer, recorder, and surveyor, died in July 1878, before he had completed surveying the Catholic cemetery.

Up to this time the St. Joseph congregation had consisted of Catholics of all nationalities. In the next few years

Carroll City-Mount Olivet Cemetery

Carroll, Iowa

Name of Property

County and State

the Catholic population increased, so that by 1885 there were 300 families. The main reason for the growth was the heavy German immigration. At that time St. Joseph Parish was composed of Irish, German, English, and French parishioners. They were primarily English-speaking and German-speaking Catholics, especially the newer immigrants (Kerwin. "Catholics" 1). About that time the parish began to form into two groups--the English-speaking and the German-speaking factions. In 1885 the latter petitioned Bishop John Hennessey of Dubuque for a German priest and a division of the parish for those who spoke only German.

The bishop ordered a census of the parish, which found that 53 percent were German-speaking. Bishop Hennessey gave his approval, the division was finalized, and Sts. Peter and Paul, known as "the German Parish," was organized in 1885, building a new church a block south of the St. Joseph, known as "the Irish Parish," buildings (Kerwin "Catholics" 2). In 1886 Sts. Peter and Paul Catholic Cemetery was established directly south of St. Joseph Cemetery. On August 18, 1927, for Sts. Peter and Paul Church Fr. Lambert Schenkelberg purchased two additional acres for \$2,000 from Fred Spieker, a widower, to add to the parish cemetery (Spieker).

The turn of the century saw Carroll continue to grow, especially to the north and west, and in 1910 the population was 3,556. Fr. Joseph Kuemper, himself an immigrant from Westphalia, Germany, envisioned a parish to serve the growing needs of Catholics on the north side of Carroll. He established St. Lawrence Parish in August 1914 as a corporate entity and a mission of Sts. Peter and Paul Parish (Kerwin. "Fr. Kuemper"). As the third Catholic parish, St. Lawrence parishioners also were buried in the Catholic cemetery.

In the early 1900s a "Crucifixion group" of 3/4 life-sized statues of Blessed Mother Mary, the Apostle John, and a crucified Christ above a cement base was installed at an intersection in the middle of the Catholic Cemetery. Memorial Day Field Masses were celebrated at this altar area from 1949 to 1961 (except 1957). Attendance ranged from 700 to 2,000 at these outdoor liturgies. In June 1959 the Catholic Cemetery Association discussed replacing the Crucifixion group with provision for a permanent altar. In the early 1960s Boyce Monumental Sales of Carroll moved and reinstalled the statues group with a new marble crucifix, corpus, and altar on a hill in the southwest part of the cemetery in the 1927 two-acre addition (Boyce).

Plots for sisters and priests demonstrate the Catholics' traditional respect for these religious leaders. With death dates ranging from 1881 to the 1990s, forty-two small white grave markers are in the southern part of the former Sts. Peter and Paul Cemetery for Franciscan Sisters who served in the parishes, schools, St. Anthony Institute, and St. Anthony Hospital in Carroll. About 1986 the Franciscan Sisters from LaCrosse, Wisconsin, ordered a cruciform FSPA marker from Boyce Monumental Sales, which sits in the middle of the plot on a concrete slab. On the cross is inscribed "Franciscan Sisters of Perpetual Adoration Rest in Peace" and their monstern emblem.

In 1922 the burial ground for priests was moved to the center of the Catholic Cemetery. Seven raised-top markers for individual priests of the 20th century, including Fr. Joseph Kuemper, surround a cruciform

Carroll City-Mount Olivet Cemetery

Carroll, Iowa

Name of Property

County and State

memorial installed around 1975. A second area at the intersection of roads in the western part of the cemetery has large vertical white gravestones for three St. Joseph Parish pastors of the early 20th century. Rev. Bradley's monument has a cement kneeler in front with "Pray for Me" etched in the top. A third area near the Crucifixion statues in the southwest part of the cemetery has four ledger grave markers for other priests who served in Carroll.

To bring about more efficient methods and perform greater service to the members of the three Catholic parishes, a new system of records was established in 1954. A system of enumeration continuous throughout the entire area replaced the block system of numbering the lots in the Catholic cemetery. New lot markers of non-corrosive material were purchased to enact this program of enumeration ("Mt. Olivet"). Some areas of the cemetery were surveyed anew for greater accuracy in establishing lot lines and to facilitate plans for special developments ("Mt. Olivet").

The St. Joseph and Sts. Peter and Paul Parish cemeteries shared the name of the Catholic Cemetery of Carroll until 1954, when the two officially became one under the name Mount Olivet Cemetery. With only one block separating them, these two parishes existed individually for almost 80 years. Then in 1964 St. Joseph and Sts. Peter and Paul were combined as Holy Spirit Parish. In 1970 Mount Olivet Cemetery's deed was transferred to the City of Carroll, and it became Mount Olivet Cemetery of the City of Carroll. Several restrictions were put into the agreement reserving certain future rights, including that "the cemetery shall be devoted primarily to the use for those persons who meet the approval of a Roman Catholic pastor attached to a church within the city of Carroll" ("City to Operate"). The City Cemetery was originally for members of all other religions; since 1970 these distinctions have diminished.

Social Activities, Fraternal Organizations, and Clubs

The Carroll community has centered many patriotic activities within the cemetery since the 1880s. Memorial or Decoration Day activities to honor the dead were some of the first and have involved many community organizations and individuals, young and old, rain or shine (except during pandemics). Memorial Day parades and services at the amphitheater in the City Cemetery have been an annual highlight of the American Legion and Auxiliary programs in Carroll. German *Vereins* or clubs were also represented in the 1800s parades. The custom of placing flags on graves of all veterans grew from approximately 20 flags in 1922 to 800 in 2019 ("Legion Auxiliary" 15). Other customs added through the years include the placing of flowers, poppy wreaths, and brass markers on graves of all veterans and deceased Auxiliary members. Respect for military veterans is permanently displayed in the Civil War Monument, which was planned by 29 local organizations to replace the 1880s Grand Army of the Republic monument. The American Legion Monument and the seven 20th century veterans' monuments in Memorial Circle further honor veterans.

Burials in the cemetery of many members of Carroll's fraternal organizations help to showcase that facet of the city's social history. The first known non-religious organization founded by the Germans in the county was probably the Carroll *Unterstuetzungsverein*, or Carroll Aid Society, which was founded in December 1872 by

Carroll City-Mount Olivet Cemetery

Carroll, Iowa

Name of Property

County and State

a number of prominent Carroll businessmen. After their successful participation in the July 4, 1876, celebration, German citizens formed the Carroll *Schuetzenverein*, a German rifle club, and a traditional German *Gesangverein*, or Choral Club, for their social and cultural life in the city and county (Reineke Chapter 3).

Members of the Signet Lodge No. 264, A. F. and A. M., were leaders and developers of businesses, organizations, and various professions. Their tombstones, primarily in the older sections of the City Cemetery, are marked with the Freemason and Eastern Star symbols, as those organizations have had a strong following in the community for over 150 years since the Masons received their charter in 1870 ("Signet Lodge"). The Independent Order of Odd Fellows (IOOF), which began in 1874, has had a marker on lot 116 in Section 1 since 1921 and also has grave markings. Odd Fellows ceremonies used to be held in the cemetery each spring. The Knights of Columbus sponsored the Memorial Day Field Masses in the Catholic Cemetery. Other fraternal societies have included the Knights of Pythias and Good Templars in the late 1800s, the Citizens' Club since 1907, the Rotary Club since 1917, the Lions Club since 1924, and the Elks since 1940.

The involvement of Carroll citizens and fraternal organizations in the upkeep of the cemetery reveals how important it was to the social fabric of the city. In the late 1800s and early 1900s, sextons and town council committees oversaw the maintenance of the burial grounds. From 1910 through 1912, the Carroll Cemetery Association was organized "to advance the work of caring for the cemeteries" ("Local News"). In March 1914 the city council contracted with the local lodge of Odd Fellows to care for the Carroll Cemetery. The lodge was greatly interested in the condition of this cemetery "as many of its deceased members find in it their last resting place and most of the living members expect that it will be the place of burial for themselves and other members of their family" ("Locals and Personals" 19 March 1914). Largely through the efforts of Carroll Lodge No. 279, the IOOF Cemetery Association, under the leadership of chairman E. A. Wissler and with the assistance of other Odd Fellows members, the city's cemetery was changed from one of neglect and disorder to a place of beauty from 1914 to 1962. The Catholic Cemetery Association was responsible for the Catholic cemeteries until 1970, when the city assumed ownership.

CRITERION C: Landscape Architecture/Architecture

Under Criterion C the cemetery is also locally significant for the National Register for its landscape architecture, particularly the 1933 Ries Addition, designed by noted landscape architect Ray Floyd Wyrick in the mid-to-late 1930s; for the architectural design of the cemetery's buildings, monuments, gates, and boulder walls during the 1930s; and for the cemetery project's being funded by the Works Progress Administration (WPA). The overall cemetery landscape reflects the influence of national movements and trends in cemetery landscape design which overlapped during the 19th to 20th centuries. Carroll's original cemetery's landscape design, the Lawn-Park/Geometric style, originated in 1873 as a formal grid pattern which followed "the classical principles of strong axial organization and bilateral symmetry" being implemented in municipal park systems during the late 19th century (Potter and Boland 6). Due to the cemetery's rolling topography and rural

Carroll City-Mount Olivet Cemetery

Carroll, Iowa

Name of Property

County and State

vistas, as well as the designs of the late 19th century cemeteries to the north and south, for the Ries Addition Wyrick adopted the 1930s Rustic/Naturalistic Park design. This design is also reflected in the cemetery's gates and boulder walls, buildings, and monuments. The Ries Addition is contiguous to the original cemetery to its north and to the two Catholic cemeteries with their late 19th century Lawn-Park/Geometric designs to its south.

19th-20th Century Design Trends: Original Carroll City Cemetery (1873), St. Joseph (1876) and Sts. Peter and Paul (1886) Cemeteries, and Ries Addition (1933)

Site 1 - Original Carroll City Cemetery 1873: Lawn-Park/Geometric Design

As America became more industrial and more urban, Americans' views on death and the proper resting place for the deceased evolved during the mid-18th into the 20th century. People were looking for places of solitude and beauty for their burial grounds as well as park-like, spacious surroundings as an escape from urban life and as a place for leisure. Spending time strolling through a cemetery became popular as people sought out an environment "that was naturalistic and totally different from that of their daily urban life" (Sloane xxii). During the early 1850s the Lawn-park cemetery design emerged "as a less crowded and cluttered alternative to the rural 'picturesque' cemetery (1831-1870s)" (Sloane 4). In 1855, "Beginning with Cincinnati's Spring Grove, lawn-park cemeteries were simpler in their layouts, more spacious and open. . . . As historian David Charles Sloane has written, 'the pastoral would replace the picturesque'" (qtd. in Eggener 106). Adolph Strauch "designed one of the first pastoral cemeteries in America" when he adapted the Cincinnati cemetery to the landscape lawn plan; he "thinned trees and shrubs, and most significantly, opened up the cemetery landscape" (Sloane 96). Strauch's design exhibited "regularity, balance, symmetry," according to an article by George Tatum published in the *American Quarterly*, in 1951, entitled "The Beautiful and the Picturesque" (qtd. in Sloane 103).

Carroll adopted the Lawn-Park/Geometric landscape design plan, with its regularity, balance, and symmetry, for its original cemetery and integrated "classical principles of strong axial organization and bilateral symmetry" that had become popular in mid-19th century urban planning (Potter and Boland 6). Given the commonalities between the new cemetery designs and the urban parks that were inspired by these designs, "classical formality was introduced to early 20th century cemetery landscapes in the axial alignment of principle avenues of approach centered on building fronts, and also in cross axes terminated by rostrums, exedras, and other focal features" (Potter and Boland 6). On January 10, 1872, a resolution was passed that directed "the trustees of the Town of Carroll" to purchase ten acres of land "to be devoted to the exclusive use of a Cemetery or Burying Ground" (*Minutes* 60-61). William S. Winnett, County Engineer, was hired to survey and plat the land in June 1872; on March 5, 1873, Winnett was paid \$20.00 for surveying the cemetery (*Minutes* 88). Finally, on February 10, 1874, Ordinance No. 12 was passed to formalize Winnett's work "that the survey and subdivision thereof into streets, alleys, blocks, etc. made by the county surveyor W. S. Winnett be and the same is hereby adopted and ratified" (*Minutes* 120). Classical formality was adopted for Carroll's original cemetery by Winnett, which integrates roadways (axes) and the bilateral symmetry they create, as well as the symmetry of the original four blocks (quadrants), with the central, circular focal point. Each quadrant is

Carroll City-Mount Olivet Cemetery

Carroll, Iowa

Name of Property

County and State

the same size and the axes all lead to a central focal point—now the site of a native stone obelisk-shaped monument built in the 1930s by WPA relief workers to honor Carroll’s Civil War veterans. A native stone semi-circular amphitheater with a rostrum is also located in this space and both face the obelisk.

Site 2 - St. Joseph (1876) and Sts. Peter and Paul (1886) Cemeteries: Lawn-Park/Geometric Design

Both the original plats for the Catholic cemeteries share much in common with the design of Carroll’s original cemetery. Each of the original Catholic cemeteries reveals characteristics of the Lawn-Park/Geometric landscape design: park-like, simple, open spaces, with balance and symmetry achieved by the strategic placement of a few roads that follow straight lines. Possibly due to the topography, the geometry of the original cemetery slightly differs from that of the Catholic cemeteries. The original city cemetery is a square shape versus the Catholic cemeteries, which are both rectangular. However, as with the original cemetery, vegetation and trees are spaced to achieve the open park-like aesthetic of the Lawn-Park/Geometric design. Scattered throughout the landscape, specific areas of the cemeteries are designated for a variety of uses: priests’ graves, sisters’ graves, a Catholic Baby Land, a potter’s field, as well as a Crucifixion group of statues from the early 1900s that were originally placed midway between the two cemeteries to the west but were relocated in the 1960s to a hill in the southwest part of the cemetery. For close to 150 years the spacious, park-like settings of both the original cemetery and the Catholic cemeteries have offered visitors and mourners a tranquil experience due to the natural beauty that surrounds them.

Site 3 - Ray Floyd Wyrick’s Ries Addition (1933): 1930s Rustic/Naturalistic Park Design

As illustrated by the discussion of the landscape designs for Carroll’s original cemetery and the Catholic cemeteries, burial places reflect prevalent design trends which, in turn, reflect the public’s evolving expectations regarding proper burial sites. In the 1930s, some landscape architects began to adopt more naturalistic, rustic designs that took cues from the uniqueness of particular landscapes. Rustic park design in Iowa first appeared during the 1910s and 1920s in state parks when two landscape architects from Iowa State University, P. H. Elwood and John Fitzsimmons “advanced the design aesthetic” (DNR 12). People’s first impressions as they entered these parks “were likely dominated by a sense of awe of the natural environment” which was both scenic and dramatic (DNR 5). They also experienced the “interplay of the structures that frame outdoor life” which were built of rustic stone and timber (DNR 5). It was during the Great Depression of the 1930s when Civilian Conservation Corps (CCC) and Works Progress Administration (WPA) relief laborers were put to work building these rustic structures in parks and cemeteries that the design proliferated. During the 1930s, promoters explained the “Design Intent: The era of ‘rustic park architecture.’ . . . celebrated handcrafted details which reintroduced pioneer building techniques. Local, natural materials of stone and timber were predominately used. . . . Structures were intended to harmonize with nature, allowing the environment to take center stage” (DNR 13). Wyrick’s landscape design achieved this harmony by integrating manmade structures into strategic areas of the two cemetery sites, while allowing his landscape design to enhance but not overwhelm the natural environment. Wyrick’s use of the rustic park architecture design for the

Carroll City-Mount Olivet Cemetery

Carroll, Iowa

Name of Property

County and State

cemetery's buildings and structures, his Rustic/Naturalistic Park landscape design for the Ries Addition, and WPA funding, which made Carroll's cemetery beautification project possible, qualify the Carroll City-Mount Olivet Cemetery for the National Register under Criterion C.

Following the Rustic/Naturalistic Park ideal of achieving harmony between manmade structures and the natural environment, Wyrick was able to masterfully achieve congruence among the three cemetery sites. He accomplished this goal by creating a landscape design for the Ries Addition that blended architectural styles which complemented the designs of the original Carroll cemetery contiguous to the north and the Catholic cemeteries contiguous to the south. Considering the cemetery's elevated location on the edge of town, with its rolling terrain and rural vistas, Wyrick adopted the 1930s Rustic/Naturalistic Park architectural design for the Ries Addition. Landscape architects "were responsible for minimizing the landscape damage done by new roads" in both national and state parks; "in particular, the landscape architects attempted to avoid straight lines in park roads" so that they, along with the structures, also harmonized with nature (Tweed et al. 68). Wyrick adopted their approach with his landscape design for the Ries Addition. In addition to congruence, the cemetery also retained its continuity with the past, as reflected not only in the varied landscape designs, that spanned the late 19th century to the early 20th century, but also in the mix of rustic monuments, structures, and buildings constructed during Wyrick's tenure. Keith Eggener believes, "'Cemeteries operate as alternate cities—cities of the dead. They are often very complex'" (qtd. in Greenfield 6). Wyrick acknowledged early on the complexity of unifying the original cemetery with the Ries Addition while also anticipating a future merger with the Catholic cemeteries.

After accepting Wyrick's letter of Agreement of December 14, 1933, the City commissioned him on January 3, 1934, to design and supervise the construction of an addition to the City cemetery on the newly acquired Ries property (City of Carroll, City Council Minutes 82-83). In his letter Wyrick enumerates his seven-point proposal to act "as your Landscape Engineer and Consultor in connection with the development of your cemetery and its addition" (City of Carroll, City Council Minutes 82). In his letter he also acknowledges "an integral part of the problem" being the unification of the cemetery tracts (City of Carroll, City Council Minutes 82).

In early December 1933, he had presented a "Preliminary plan for unification and beautification of the two cemetery tracts" and "Possible unification of the Catholic cemetery. . . with the city's two tracts" ("Plan to Unify"). His final design achieved the congruence necessary for unification. Ironically, this was achieved not only because of Wyrick's landscape design, but also because of the rustic park architecture adopted for the cemetery's structures and buildings. Works Progress Administration (WPA) relief workers used local field stones throughout the cemetery to achieve coherence and to bring Wyrick's Rustic/Naturalistic Park design to fruition.

In a 1929 publication of *Park and Cemetery* Wyrick discusses an important ideal he believed should be expressed in cemeteries' landscapes: "we try to soften grief and think of the graves of our dead as melted into

Carroll City-Mount Olivet Cemetery

Carroll, Iowa

Name of Property

County and State

the peace of a quiet landscape” (qtd. in Maturri 14). Wyrick also achieved this ideal with his landscape design that offered scenic spaces for contemplation and stone buildings and structures that conveyed a sense of strength and permanence. His belief that a cemetery’s landscape plays a role in softening grief and offering moral uplift is analogous to the Great Depression’s emotional toll on individuals and the role Franklin D. Roosevelt’s New Deal/WPA played in easing grief and economic hardship by offering jobs and hope.

According to the local newspaper, Wyrick spoke to the Carroll Chamber of Commerce on February 20, 1934, about his cemetery plan for Carroll: “For communities the size of Carroll” Wyrick explained “he favored ‘taking care of all tastes that might arise’” (“Cemeteries Are Compared”). He believed his Rustic/Naturalistic Park design reflected Carroll’s social values. Carroll was a hardworking, resilient, family-oriented community that wanted an attractive resting place in which to mourn and honor the dead. When Wyrick was commissioned to design and supervise the construction of the Ries Addition, his vision was accepted and promoted by city leaders who aggressively pursued funding from local, state, and federal sources, mainly the WPA, in order to hire local relief laborers to make sure the project came to fruition.

Under native Iowan Harry Hopkins’ leadership, the WPA became a significant factor in Carroll’s ability not only to stimulate its economy by offering employment, but also its ability to fund needed infrastructure projects. Because of Mayor Arthur N. Neu’s and the City Council’s leadership, the local relief workers’ skills, and WPA funding, Carroll’s cemetery project was completed. The right people came together at the right time.

Wyrick worked from 1934-1941 on Carroll’s cemetery unification and beautification project. His original hand-drawn plan for the Ries Addition still exists and is in the possession of the City of Carroll. His diagram includes the title “Plan For Addition To City Cemetery Carroll, Iowa” as well as his signature and title, Landscape Engineer (Wyrick). His landscape design incorporates curving roads that follow the addition’s rolling, elevated terrain, which showcase nearby farm fields because of the cemetery’s location on the edge of town. He divides the platted lots into several areas of various sizes and shapes. Lots are laid out in straight rows that intersect with the outer lots arranged to accommodate the curvilinear blocks. The roads and platted areas are spaced far enough apart to open up the landscape and provide views of the burial grounds to the north and south. Wyrick includes a small heart-shaped section in a spacious grassy area for a Baby Land; a circular area in Block 8 for a garden or Mausoleum; a rectangular area for a Garden or Mausoleum in Block 10; and a small wedge-shaped area between Blocks 8 and 10 for the American Legion Memorial. A rectangular “Field of Honor” War Burials space is included in Block 11 but has never been developed. These varied geometric shapes create congruity with the cemeteries to the north and south.

Finally, two rectangular-shaped buildings are included in the upper left-hand corner. The rectangle to the north is for “Toilets” and the rectangle to the south of it is for a “Shelter Bldg.” These buildings were constructed by local WPA workers, during the 1930s, of native field stone, following the rustic park architecture aesthetic. Overall, Wyrick’s Rustic/Naturalistic Park design creates an uncluttered landscape with winding roads that create scenic vistas. It also offers visitors a variety of experiences by blending rustic park architecture within

Carroll City-Mount Olivet Cemetery

Carroll, Iowa

Name of Property

County and State

the Ries Addition's plan. Overall, Wyrick achieves the harmony intended that allows "the environment to take center stage" (DNR 13).

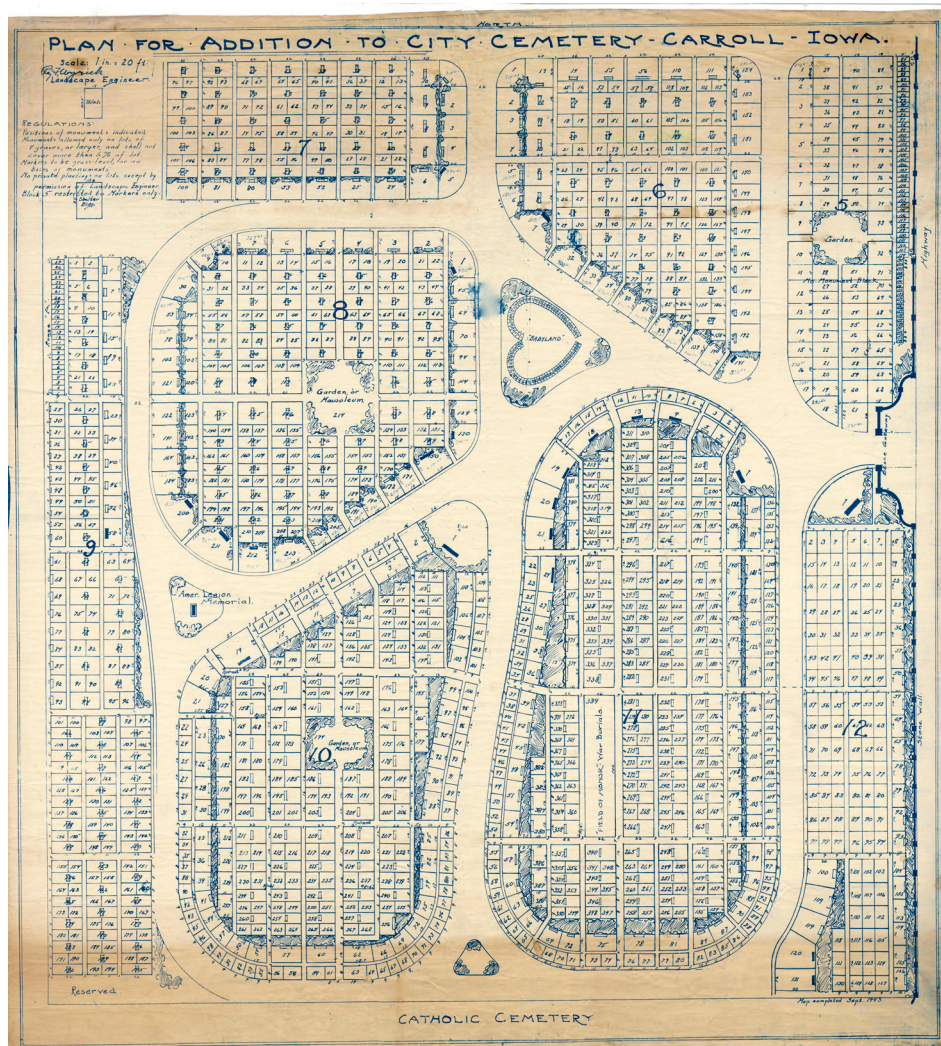

Figure 26 – Plat of ten-acre Ries Addition in the Carroll City Cemetery, designed by Ray F. Wyrick.

Plat map from Carroll City Hall. (Top of map is North)

To implement Wyrick's plan the City of Carroll needed help from the federal government. On October 24, 1934, the *Carroll Daily Herald* ran an article in which E. H. Hullock, chairman of the Iowa Emergency Relief Administration (IERA), which released federal funds throughout the state, explains that both President Roosevelt and Harry Hopkins believe for federal programs to succeed "the support and cooperation of local organized groups" is necessary ("Cities"). Both Hopkins and Roosevelt also "wanted to get the federal government out of giving relief and into providing jobs for the unemployed" (McJimsey 76). City leaders and civic organizations were ready to cooperate and Carroll's unemployed were ready to go to work.

In 1934 city leader Arthur N. Neu (1893-1960) became mayor. Neu's leadership would become the driving

Carroll City-Mount Olivet Cemetery

Carroll, Iowa

Name of Property

County and State

force for implementing Wyrick's vision and completing Carroll's cemetery project. Neu filled that leadership role until 1960. During his tenure Neu committed city funds to the cemetery project and sought funds from local civic groups to create construction jobs at the cemetery. In November 1934, the Carroll City Council passed a resolution that committed funds for the cemetery project (City of Carroll, City Council Minutes 163). Funding from both the Iowa Emergency Relief Administration and the city provided momentum for the cemetery beautification project.



Figure 27 – Civil War Monument, amphitheater, and rostrum, 1939, looking NE.

Photograph from Iowa State University Archives, Ames, IA.

In early 1935 a local civic group also became involved and committed funds for local relief workers. Displayed on the front page of the March 27, 1935, *Carroll Daily Herald* is a photo captioned “New G.A.R. Monument Completed” with an article below. This article explains that a new monument “has been erected at the city cemetery to replace the old one that was blown over and broken by wind some time ago. Sponsored by the cemetery committee of the I.O.O.F. lodge of Carroll, relief workers have been building the new monument of native stones for the last couple of weeks” (“New Monument”). Handcrafted of native field stones, the Civil War obelisk-shaped memorial, which is located in the circular area of the original cemetery, reflects the rustic park architecture design.

Carroll City-Mount Olivet Cemetery

Carroll, Iowa

Name of Property

County and State



Figure 28 - 1935 Maintenance/shelter house/chapel building in City Cemetery looking NW.

Carroll Daily Herald Newspaper June 11, 1935

Three months later a native stone cemetery shelter house building was nearing completion. A June 11, 1935, local newspaper article explains the IERA “furnished the labor and \$286 worth of materials. The community (partly through the I.O.O.F. cemetery committee) furnished the foreman and the balance of the materials at a cost conservatively estimated by Foreman Frank Walz at about \$450” (“Cemetery Shelter House”). Additionally, a “Works Progress Administration Project Application” form, dated September 10, 1935, indicates the City of Carroll applied for and was approved to receive \$18,982.00 for their cemetery project. The city’s (sponsor’s) share of the cost was \$2,630 for a total project cost of \$21,612.00 (United States, Works Project Administration 17734). The form also explains the scope of the project, which includes the new addition, improvements to the original cemetery, as well as an array of infrastructure, such as driveways, drainage systems, fencing, tiling, curb and gutter, and finishing the fireplace, partition, and ceiling in the tool house (United States, Works Project Administration 17734).

Wyrick is included on the “Project Proposal” form which asks: “By whom were the plans and specifications prepared?” The name and title indicate “Roy [sic] Wyrick, Landscape Engr” (United States, Works Progress Administration 17736). The following page indicates the federal government contributed \$15,084.00 for labor and the city of Carroll was responsible for \$1,380.00, for a total labor cost of \$16,464.00 (United States, Works Progress Administration 17737).

According to the local paper, an article with the title “Will Begin Work on \$21,000 Relief Job at Cemetery

Carroll City-Mount Olivet Cemetery

Carroll, Iowa

Name of Property

County and State

Monday,” December 9, 1935, explains the scope of the project: “completion of a new stone entrance, repairing of drives. . . erection of a fence. . . . The cemetery improvement was begun as a CWA project several years ago and work has been done on it by relief crews at various times since it was begun” (“Will Begin Work”).



Figure 29 - WPA workers prepare the site for the east gateway looking W.

Photograph from *Daily Times Herald*, Dec. 11, 1935

A prominent photo with the headline, “Work in Full Swing On \$21,000 Carroll Cemetery Improvement,” appears in the December 11, 1935, edition of the local paper and explains: “Approximately 22 men are working on the project and more will be added. . . . Designed as a work relief project, the work includes completion of a new stone entrance, repairing of drives, construction of drainage and water systems, erection of a fence, completion of marking of plots and construction of curbs and gutters (“Work in Full”).

In 1936, “to modernize the old parts of the Carroll cemetery, a large WPA gang went over the whole ground, taking up the old sod, leveling down the raised lots and filling the alleys, and then replacing the sod. The result was to transform the whole appearance of the old graveyard. In many cases, the old monuments had to be straightened and lowered, and it was a tremendous task of modernization” (“Carroll Cemetery Project”).

On January 23, 1937, Mayor Neu called a special session of the Carroll City Council to address progress on the cemetery project, specifically the new stone fence. Wyrick was asked to attend as well as the local head of the WPA, the cemetery sexton, and work foreman, “to discuss with the council the proposition of going ahead with the work of building the fence at the new cemetery, as outlined in the project proposal dated August 27th, 1935. Mr. Neu stated it was his desire that the fence be built” (City of Carroll, City Council Minutes 20). After considerable discussion, Mayor Neu’s leadership prevailed and a motion passed which directed “that the City

Carroll City-Mount Olivet Cemetery

Carroll, Iowa

Name of Property

County and State

Engineer be instructed to start immediately with the installation of the rock fence as designed in Mr. Wyrick's plans" (City of Carroll, City Council Minutes 22).

Mayor Neu's desire to have the cemetery's new stone fence completed became a reality. *The Carroll Daily Herald*, on May 29, 1937, reports: "The new stone fence bounding the Carroll cemetery on the east side, has been completed by WPA labor and has recently been approved by the department. The completion of the project has occurred just in time to permit its full beauty to be seen at the annual Memorial Day services which will be held there Monday" ("Stone Fence"). On June 1, 1937, the front page of the same paper includes a photograph and caption of the native stone east gateway. A caption follows: "This is the new gateway of the WPA-built stone fence which flanks one side of the Carroll Cemetery. Architecturally attractive, the fence won the admiration of WPA officials who inspected it recently" ("This is the").



Figure 30 - American Legion Monument looking SW, Sep. 21, 1938.
Photograph from Iowa State University Archives, Ames, IA.

Also, in 1937, because of the generosity of Carroll's local Maurice Dunn American Legion Post, a new stone monument was erected in the Ries Addition. The Post provided the funds for the materials and the WPA provided the labor. A local news article explains, "it will be located in a triangular plot on top of a hill to the west edge of the cemetery, giving a commanding view of the entire burial ground" ("Traner Installed"). Wyrick chose the location for this stone monument, which is in his Ries Addition plan.

At the end of 1937 the cemetery received national recognition, as highlighted in a local newspaper article: "Carroll Cemetery Project Has Won Recognition All Over The United States." Though it mainly focuses on a chronology of the cemetery's expansion and beautification process, the article concludes by commending city

Carroll City-Mount Olivet Cemetery

Carroll, Iowa

Name of Property

County and State

leaders: “Mayor A. N. Neu, aided by the present city council, deserves great credit for foresight in realizing the possibility of carrying out this tremendous project, by showing the willingness to work along with the government in a permanent development, the benefits of which will last for centuries” (“Carroll Cemetery”).

The following year, on October 27, 1938, the same paper summed up Carroll’s WPA funded cemetery project: “WPA laborers on this project have . . . built an entrance-way of native rock and masonry; constructed a native stone and masonry wall surmounted by iron fence along the boundaries of the cemetery; put in pavement; erected an American Legion monument of native rock; built an open-air rostrum of native stone; planted trees and other work in keeping with the cemetery development” (“167 Employed”). Wyrick’s Rustic/Naturalistic landscape design won the recognition it deserved. More importantly, for Carroll, it remains a beautiful, burial site that provides a tranquil environment suited for reflection, reading, walking—for enjoying nature.

By 1939 the finishing touches were being added to the cemetery. At the March 6, 1939, City Council meeting “A letter from Ray F. Wyrick, Landscape Engineer, was read in regard to the purchase of trees for the cemetery” (City of Carroll, City Council Minutes 315). By March 28, 1940, the remaining council work with Wyrick concerned some landscaping needs (City of Carroll, City Council Minutes 437). Finally, at the city council’s March 24, 1941, meeting, “A card from Mr. Wyrick in regard to shipment of nursery stock for the cemetery was read” (City of Carroll, City Council Minutes 99).

Wyrick’s vision of a Rustic/Naturalistic Park landscape design and his integration of rustic park architecture provided the inspiration for city leaders to support Carroll’s cemetery beautification project. Mayor Neu and the City Council’s leadership provided the impetus for civic groups to get involved. Finally, the WPA provided funds to create jobs for the unemployed, whose skills contributed to the project’s success. Together they created beauty during the dark time of the Great Depression. For these reasons Carroll City-Mount Olivet Cemetery is eligible for the National Register under Criterion C.

Wyrick’s Commissions in Addition to Carroll, Iowa

In addition to the Carroll Cemetery, Wyrick’s other commissions in Iowa include Mason City’s Elmwood-St. Joseph Municipal Cemetery (1930s), Oskaloosa’s Edmundson Memorial Park & Recreational Center (1936-38), Oskaloosa’s Forest Cemetery (1949), Ames Cemetery’s Forest Lawn & Oakwood plats (1960s), Chariton’s Cemetery (1924), Newton’s Union Cemetery (no date given), and Ottumwa’s Cemetery Historic District (1930s-1942). His cemetery commissions outside of Iowa include Grand Forks, North Dakota’s Memorial Park and Calvary Cemetery (1930s); Manchester, New Hampshire’s St. Joseph Cemetery (1946); Macon, Georgia’s Riverside Cemetery (1952); and Barre, Vermont’s Hope Cemetery (1929).

HISTORY AND DEVELOPMENT OF CARROLL AND ITS CEMETERY

1850s - 1870s

Carroll was probably recognized as an independent county on the basis of the census of 1856. All of the

Carroll City-Mount Olivet Cemetery Carroll, Iowa
Name of Property County and State

settlements where people lived were in the eastern row of townships. Carrollton, the only settlement with the dignity of a name, had fewer than a dozen houses and about 30 inhabitants, but was chosen as the county seat (Maclean 29).

In 1866, the North Western Railroad completed its tracks to the present site of Carroll. The following year a few families settled, and John I. Blair filed the first plat of the town in August 1867. Because of the railroad, the town grew rapidly. In the fall of 1867, the North Western Railway proposed to the County Board of Supervisors that if the county seat was moved from Carrollton to Carroll, which was on their main line, the railway would deed Block 15 of the new town of Carroll to the county for a court house, in consideration of one dollar ("History of Carroll County" 110). After a controversial election and an overnight removal of government documents, Carroll City became the new county seat April 28, 1868.

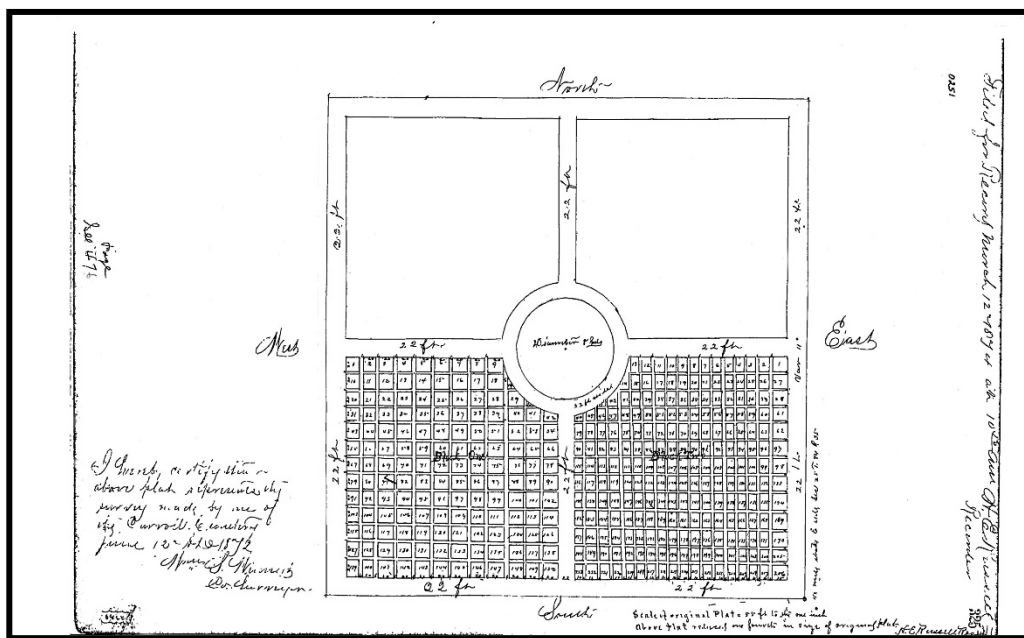

Figure 31. Plat of Blocks 1 and 2 of the original City Cemetery, Carroll, IA, by William S. Winnett, 1872.

Plat map from Carroll County Courthouse, Carroll, IA. (Top of map is North)

During the 1860s several bodies, mostly children, were buried just west of the present (original) city cemetery. After 1872 when the cemetery was platted, they were later reinterred alongside their families within the platted cemetery. After Carroll had been incorporated in September 1869, the first official mention of the original cemetery was at the twelfth regular meeting of the town council in 1870 to procure grounds for a cemetery (*Minutes* 12). At their April 1871 meeting, the mayor appointed a committee to see how many citizens of the town would purchase lots in a cemetery (*Minutes* 22). The next January the council resolved to purchase from the Blair Town Lot Company 10 acres of land for \$10 per acre "to be devoted to the exclusive use of a Cemetery or Burying Ground for the use of the inhabitants of said town & vicinity" (*Minutes* 60-61). William S. Winnett, county surveyor, surveyed and platted the first two sections of the site in 1872. For ten dollars,

Carroll City-Mount Olivet Cemetery

Carroll, Iowa

Name of Property

County and State

subscribers could receive a deed for one double lot or two single lots, or one single lot for five dollars in the new cemetery (*Minutes* 63-64). A board fence was constructed around the grounds in 1873, and in the spring of 1877 landscaping progressed in the cemetery.

By the late 1860s a railroad station for the Chicago and North Western Railroad (C&NW) had been constructed. Businesses with residences upstairs followed. The first schoolhouse was built in 1868. The population of Carroll County began to grow rapidly, fueled in large part by hundreds, and then thousands of German immigrants. Eventually, the German population in the county became the majority.

In “The German Heritage of Carroll County, Iowa” on Carroll County IAGenWeb History Journal, David Reineke traces the growing German influence:

Although Germans and Americans lived side-by-side in Carroll during the 1870s, two distinct cultures developed, a situation which lasted well into the twentieth century. For the most part, Germans and Americans each had their own businesses, churches, and social organizations. Carroll quickly developed into the center of German cultural and business life in the county. . . . During the early 1870s, a number of prominent German-owned businesses were established alongside their American-owned counterparts. . . . over time the German businesses of Carroll would expand into virtually every market. German entrepreneurs would establish blacksmith shops, hotels, grocery stores, general stores, newspapers, and banks—all with a distinctly German character. . . . No business was more instrumental to the growth and fostering of German culture in Carroll and throughout the county than *Der Carroll Demokrat*, the first German-language newspaper established in Carroll County in 1874. . . the paper also played a major role in German business and cultural affairs. (Reineke Chapter 3)

The second third of the cemetery was founded by the Catholic parishioners. A major part of the German (and Irish) cultures was their predominantly Catholic religion, which established St. Joseph Parish in 1874 for the Irish and English and Sts. Peter and Paul Parish in 1886 for the Germans. In 1876, within two years of St. Joseph Parish being founded, parishioners purchased land south of the City Cemetery to create the Catholic Cemetery of Carroll. In 1886 Sts. Peter and Paul Catholic Cemetery was established south of St. Joseph Catholic Cemetery.

A disastrous fire that started in a Fourth Street saloon on September 25, 1879, destroyed the downtown business district from the railroad tracks north to Sixth Street and between Main and Adams Streets. Besides all of the businesses lost, many residences were destroyed because citizens lived in or above the stores. Rebuilding began within weeks as the frame buildings were replaced with brick structures.

Carroll City-Mount Olivet Cemetery

Carroll, Iowa

Name of Property

County and State

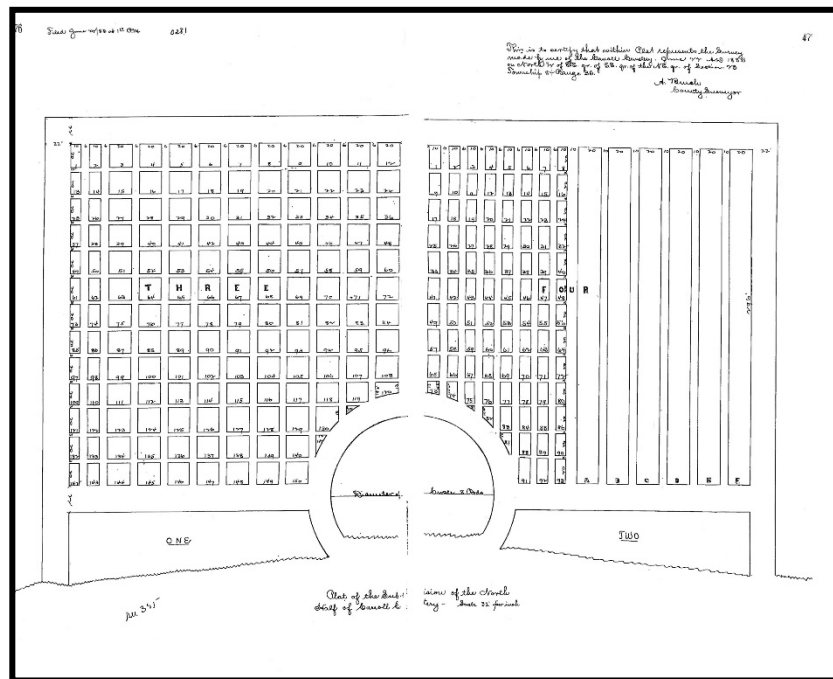

Figure 32. Plat of the north Blocks 3 and 4 in the Original City Cemetery of Carroll, IA, by A. Bruch, 1885.

Plat map from Carroll County Courthouse, Carroll, IA. (Top of map is North)

1880s - 1890s

The Carroll City Cemetery continued to develop on the north end of the district. Since the early 1880s, Memorial Day parades and services at the City Cemetery have been an annual highlight of the American Legion and Auxiliary programs in Carroll. In the mid-1880s the Grand Army of the Republic (GAR) Civil War Monument was installed in the middle circle to honor Civil War soldiers. This structure was replaced by the stone Civil War Monument in 1935-1936. In June 1885 County Surveyor A. Bruch made a plat of the newly surveyed [north] half of the cemetery into lots ("County Government"). A woven wire fence replaced the wooden fence in 1894.

Besides the rebuilding of the downtown after the 1879 fire, the 1880s through the early 20th century saw progressive industrialization efforts in Carroll. As a major employer and means of transportation in the late 1800s and early 1900s, railroads played a significant role in the founding of the city, its economy, and its growth. At one time eleven sets of tracks ran through Carroll. Over 60 trains per day still travel through the city.

1900s - 1920s

In 1905 the old bandstand from the courthouse park was removed to the cemetery, where it was fixed up and

Carroll City-Mount Olivet Cemetery

Carroll, Iowa

Name of Property

County and State

used as a tool house until it was replaced by the 1935 maintenance building/shelter house/chapel. Following the town council's Cemetery Committee, from 1910 through 1912 the Carroll Cemetery Association supervised and maintained the burial grounds. The Independent Order of Odd Fellows Cemetery Association was contracted for this work from 1914 to 1962, when the city took over.

In January 1925 the City Council and interested citizens discussed the city's purchase of the Adam Ries plot of ten acres of land adjoining the city cemetery. On this plot the city had an option which expired in February. The plan considered most advisable at that time was for the city "to secure the plot of ground at the best possible figure, then thoroughly grade and level off the entire ten acres, plot it into lots of a certain size that would sell for \$35 each and then advertise the lots or hold a sale of them in order to raise sufficient funds to pay for the plot" ("City Plans"). New concrete drives and streets would also be put in. An estimated 800 lots could be plotted on the ten acres, which the city needed for cemetery purposes.

On August 18, 1927, for Sts. Peter and Paul Roman Catholic Church Fr. Lambert Schenkelberg purchased two acres for \$2,000 for a needed expansion of the parish cemetery (Spieker).

1930s – 1970

The 1930s saw the middle third of the cemetery added to the historic district. In 1933 the city council moved to offer the Ries Estate \$300 per acre "for the ten acres adjacent and south of the present City Cemetery" (City of Carroll, City Council Minutes 42). At their July 31, 1933, meeting, the council accepted a counter offer of \$350 per acre for "cemetery purposes" (City of Carroll, City Council Minutes 47). In December the council hired Ray Floyd Wyrick of Des Moines to design the landscaping and structures of the new Ries Addition for the Cemetery Beautification Program. When federal funds for Public Works projects became available to the state, Works Progress Administration relief workers were hired to execute Wyrick's plans between 1935 and 1941. Most of the contributing buildings and structures in the cemetery were built during this time, such as the wrought iron and stone fence that replaced the 1911 iron fence and gates.

Following the Beautification Program, a new ordinance governing the City Cemetery in August 1940 set up regulations for the proper care of the burial grounds and the powers of the sexton. The city and the cemetery committee were given authority to make additional regulations as they deemed proper. Memorial Day Field Masses were celebrated at the Crucifixion statues altar area in the middle of the Catholic Cemetery from 1949 through 1961.

Until 1954 the two separate parish cemeteries shared the name of the Catholic Cemetery of Carroll; then the two officially became one with the name Mount Olivet Cemetery under a reorganization plan. With only one block separating them, the two parishes existed individually for almost 80 years. In 1964 St. Joseph and Sts. Peter and Paul were combined as Holy Spirit Parish, and in 1970 Mount Olivet Cemetery's deed was transferred to the City of Carroll, combining all the City Cemetery, the Ries Addition, and Mount Olivet

Carroll City-Mount Olivet Cemetery

Carroll, Iowa

Name of Property

County and State

Cemetery into one entity. At a special meeting April 23, 1962, the city council voted to take over the perpetual care trusteeship of the Carroll City Cemetery from the IOOF Lodge to comply with Iowa laws regarding enterprises. On motion in February 1965, the council approved the bill of Badding Construction Co. in the amount of \$2,969.54 for the construction of a garage in the cemetery (“Council Meetings”).

Post Period of Significance: 1970s – Present

On January 31, 1972, the City of Carroll purchased 8.8 acres of land located south of the Mt. Olivet Cemetery and north of South Clark Street from the Grossman estate for \$16,500 (“Amend”). The land was scheduled to be used for an addition to the City Cemetery, but it is not included within the boundaries for the present nomination. As of October 2021 in the nominated site, 18,375 graves have been plotted. Among these, 8,830 are occupied; 5,613 are owned; and 3,180 are available. A new cemetery office and maintenance building was built in 2016-2017 in the southeast corner of this area at the corner of South Grant Road and Clark Street.

Carroll’s evolution in the 20th century included the urban renewal programs creating the town’s slogan of “Iowa’s Newest City.” From 1963 to 1974 a massive urban renewal project was undertaken to remedy a deteriorating business district, absentee ownership, and declining tax base. The city purchased and demolished 48 buildings and rehabilitated 22 others. Other changes included new sidewalks, canopies, street resurfacing, wiring, parking lots, and sewers. In 1964-1965 the 1887 courthouse was demolished and a new Carroll County Courthouse was built. In a second urban renewal program in 1990 the city again bought properties for two retail developments (*Carroll Through the Years* 98). From 2012 to the present, Corridor of Commerce projects are ongoing to upgrade streetscapes and intersections through the downtown and outlying areas, the library has been remodeled and expanded, and a new county jail is under construction.

Community interest in historic preservation has grown from the 1970s to the present. National Register listings in Carroll include the Carnegie Library Building (added 1976); the American Express Building, also known as Carroll Express Building (added 1990); the Chicago & Northwestern Passenger Depot and Baggage Room, also known as Carroll Depot and Baggage Room (added 1990); and six bridges added in 1998.

The City of Carroll has grown in population and geographic area, but the cemetery remains in its original location. Generations of citizens have visited and been visited in its boundaries. The 1879 fire, the industrial development in the early 1900s, and urban renewal in the late 1960s and 1990s radically altered Carroll’s business and residential districts, but the cemetery has retained its permanence and significance. The 150th anniversary of the cemetery’s platting will be celebrated in 2022.

Carroll City-Mount Olivet Cemetery

Carroll, Iowa

Name of Property

County and State



Figure 33. Aerial view of southeast section of Carroll in 1962. Photograph from Kuemper High School Alumni Office, Carroll, IA
(Top of aerial photo is East.)

NOTABLE INDIVIDUALS BURIED IN THE CARROLL CITY-MOUNT OLIVET CEMETERY

Isaac Newton Griffith (1813 - 1890), one of the petitioners to incorporate the Town of Carroll, first mayor, one of ten men who purchased the Carroll City Cemetery and donated it to the city, charter member of Signet Lodge No. 264, A.F. & A.M.

William Gilley (1830 - 1912) one of the original settlers in the county, instrumental in having the county seat moved from Carrollton to Carroll City; county treasurer, sheriff, clerk of the district court, bank owner, lumber and coal yard owner, city councilman, mayor, and charter member of the first Masonic organization in Carroll County.

August Boehme (1844-1906) a Confederate Veteran of the Civil War, enlisted December 21, 1861, in 20th Louisiana Infantry Co. F, Confederate States of America, reaching the rank of sergeant; captured June 22, 1864, near Atlanta, Georgia, came north from Texas to Kansas, then to Carroll in the early 1880s, school teacher, employee of Judge Paine's abstract office, expert in work on court house records; his handwriting on county records reflects his skill and superior penmanship. His name is one of the 68 names on the Civil War

Carroll City-Mount Olivet Cemetery

Carroll, Iowa

Name of Property

County and State

Monument in the Carroll cemetery.

Rev. Joseph Kuemper (1855 - 1923) founder of St. Anthony Hospital, St. Angela Institute (a domestic science school for girls), in Carroll; and Maple River, Lidderdale, and St. Lawrence Parishes; pastor of Sts. Peter and Paul Parish; Kuemper Catholic High School is named after him.

Miss Alice Manning (1866 - 1945) leading real estate owner and businesswoman, owner of five apartment buildings plus business buildings with upstairs apartments, operator of the New York Bargain Store, first female coal dealer in Iowa, largest individual property owner in Carroll in 1928.

Arthur Nicholas Neu (1893 - 1960), a lifelong resident of Carroll, served the city during one of its greatest periods of growth. While he was serving 14 terms as mayor, the population of Carroll increased by nearly 3,000, and large areas of land were annexed to the city. Instrumental in the expansion of the Carroll cemetery, he was past president of the Carroll County Bar Association, member of the State Bar Association, American Legion (commander, 1927 - 1934), and a charter member; was a 32nd degree Mason and a member of the Masonic Lodge (Consistory, Commandery and Shrine), Order of the Eastern Star, Acacia fraternity (national counselor, 1927 - 1929); Delta Theta Phi, Elks, Chamber of Commerce, and Carroll Country Club.

Msgr. Leo Lenz (1913 - 1985) founder and first superintendent of Kuemper Catholic High School from 1953 to 1961, director of the Catholic Cemetery and secretary of the Catholic Cemetery Association, pastor of Holy Spirit Parish, superintendent of schools, deanery director of the Catholic Youth Organization, member of the initial New Hope Village building committee, finance chairman of their campaign for funds in Carroll, chaplain of the Elks Lodge; and a member of the Fourth Degree Knights of Columbus, the board of New Hope Village in Carroll, and the planning committee for Fairview Elementary public school.

Arthur "Art" Alan Neu (1933 - 2015) son of Arthur N. Neu, state senator from 1967 to 1973, Iowa Lt. Governor from 1973 to 1979, Carroll city attorney; mayor from 1982 to 1985, during which he oversaw the location of the Carroll DMACC campus; he served on the Iowa Board of Regents, Iowa Board of Corrections, Iowa Public Radio Board, Iowa Legal Aid Board, St. Anthony Regional Hospital Board, Carroll Area Development Corporation, New Hope Village Board, Advisory Board to the Culver Foundation, and Iowa Supreme Court Budget Committee; recipient of the University of Northern Iowa Leadership Award and an Honorary Doctorate from the University of Iowa for distinguished service for exceptional contributions for advancing research and educational opportunities.

ARCHAEOLOGICAL ASSESSMENT

No archaeological remains within or beyond the footprint of the Carroll City-Mount Olivet Cemetery were assessed as part of this nomination. Although the Sioux and Pottawattamie peoples used the lands around the present-day cemetery grounds as part of their trail from Indian town in Cass County through Carroll County to Big Grove in Sac County, no archaeological records or artifacts from this location are known by the nomination authors. Consideration should be given to potential archaeological concerns during any future work within the cemetery.

ACKNOWLEDGEMENTS

The nomination was made possible through the efforts of resources including Jake Bruggeman, Cemetery Sexton; Jack Wardell, Parks and Recreation Director; Mike Pogge-Weaver, City Manager; Laura Schaefer,

Carroll City-Mount Olivet Cemetery

Carroll, Iowa

Name of Property

County and State

City Clerk; Kelly Schlechta, Support Staff, City of Carroll; Deb Goetzinger, Deputy Clerk, City of Carroll; Judy Schreck, Office Manager, Carroll County Assessor's Office; Carroll County Courthouse personnel, Kuemper Catholic Alumni Association, and members of the Historic Preservation Commission. These volunteers assisted with accessing primary sources. Laura Sadowsky, State Historian/Historic Preservation Specialist, assisted with editing throughout the nomination process.

Carroll City-Mount Olivet Cemetery

Carroll, Iowa

Name of Property

County and State

9. Major Bibliographical References

Bibliography (Cite the books, articles, and other sources used in preparing this form.)

“Amend Renewal Appraisal Contract.” *Carroll Times Herald*, 4 Feb. 1972, *The Newspaper Archives of Carroll Public Library*.

“Annual Field Mass.” *Carroll Daily Times Herald*, 1 June 1951, *The Newspaper Archives of Carroll Public Library*.

Boyce, Larry. Personal interview. 21 Feb. 2020.

“Carroll Cemetery Project Has Won Recognition All Over The United States.” *Carroll Daily Herald*, 31 Dec. 1937, *The Newspaper Archives of Carroll Public Library*.

“Carroll County.” *History of Western Iowa: Its Settlement and Growth*.
books.google.com/books/about/History_of_Western_Iowa_Its_Settlement. Sioux City: Western
Publishing, 1882.

Carroll, Iowa: Community Demographic Profile. The Retail Coach, 2021.

Carroll Through the Years from 1867 to the Present. Carroll, Iowa: Historic Preservation Commission of
Carroll, 2017, pp. 90-91.

“Cemeteries Are Compared to a Business Firm.” *Carroll Daily Herald*, 21 Feb. 1934, *The Newspaper Archives
of Carroll Public Library*.

“Cemetery Shelter House Nears Completion.” *Carroll Daily Herald*, 11 June 1935, *The Newspaper Archives of
Carroll Public Library*.

“Cemetery wall project achieves fundraising goal.” *Daily Times Herald*, 20 Oct. 2005, *The Newspaper
Archives of Carroll Public Library*.

“Cities Are Laying Plans for Raising Money for Relief.” *Carroll Daily Herald*, 24 Oct. 1934, *The Newspaper
Archives of Carroll Public Library*.

City of Carroll, City Council Minutes, 3 Jan. 1934, pp. 82-83.

---, ---, 5 Nov. 1934, p. 163.

---, ---, 23 Jan. 1937, pp. 20-22.

---, ---, 6 Mar. 1939, p. 315.

Carroll City-Mount Olivet Cemetery

Carroll, Iowa

Name of Property

County and State

---, ---, 28 Mar. 1940, p. 437.

---, ---, 24 Mar. 1941, p. 99.

“City plans to buy Ries property for cemetery addition.” *The Carroll Times*, 8 Jan. 1925, *The Newspaper Archives of Carroll Public Library*.

“City to Operate Catholic Cemetery.” *Carroll Daily Times Herald*, 29 Oct. 1970, *The Newspaper Archives of Carroll Public Library*.

“Council Meetings City of Carroll, Iowa.” *Carroll Times Herald*, 26 Feb. 1965, *The Newspaper Archives of Carroll Public Library*.

“County Government.” *Carroll Sentinel*, 5 June 1885, *The Newspaper Archives of Carroll Public Library*.

Eggener, Keith. *Cemeteries*. Norton/Library of Congress, 2010.

Greenfield, Rebecca. “Our First Public Parks: The Forgotten History of Cemeteries.” *The Atlantic*. 16 Mar. 2011, www.theatlantic.com. Accessed 4 December 2020.

“History of Carroll County.” *Atlas of Carroll County Iowa*. Iowa Publishing, 1906, p. 110.

History of Western Iowa: Its Settlement and Growth. Western Publishing, 1882.

Iowa Department of Natural Resources. *Iowa State Parks Design Guide*. Nov. 2011. www.iowadnr.gov. Accessed 23 Jan. 2021.

Kerwin, James F. “Catholics Trace Century of History.” *Carroll Daily Times Herald*, 13 Sep. 1976, *The Newspaper Archives of Carroll Public Library*.

Kerwin, James F. “Fr. Kuemper Left an Indelible Mark.” *Carroll Daily Times Herald*, 14 Sep. 1976, *The Newspaper Archives of Carroll Public Library*.

“Legion Auxiliary Works for Carroll Community’s Benefit.” *Carroll Times Herald*, 19 June 1953, *The Newspaper Archives of Carroll Public Library*.

“Local News.” *Carroll Sentinel*, 9 Aug. 1910, *The Newspaper Archives of Carroll Public Library*.

“Locals and Personals.” *Carroll Times and Carroll Sentinel*, 19 Mar. 1914, *The Newspaper Archives of Carroll Public Library*.

Carroll City-Mount Olivet Cemetery

Carroll, Iowa

Name of Property

County and State

Maclean, Paul. *History of Carroll County Iowa*. Vol. 1., S. J. Clarke Publishing, 1912.

Matturri, John. "Windows in the Garden: Italian-American Memorialization and American Cemetery." *Ethnicity and the American Cemetery*, edited by Richard E. Meyer, Bowling Green State University Popular Press, 1993, pp. 14-35.

McJimsey, George. H. *Harry Hopkins: Ally of the Poor and Defender of Democracy*. Harvard University Press, 1987.

Minutes of The Incorporate [sic] Council of the Town of Carroll 1869-1878. Carroll City Hall.

[All references to the Town/City Council actions from 1869 to 1878 are from this source.]

"More Reminiscences." [sic] *The Carroll Herald*, 20 Mar. 1901, *The Newspaper Archives of Carroll Public Library*.

"Mt. Olivet Is Name Chosen For Cemetery." *Carroll Daily Times Herald*, 1 May 1954, *The Newspaper Archives of Carroll Public Library*.

"New Monument Completed at City Cemetery." *Carroll Daily Herald*, 27 Mar. 1935, *The Newspaper Archives of Carroll Public Library*.

"167 Employed In County on WPA Projects." *Carroll Daily Herald*, 27 Oct. 1938, *The Newspaper Archives of Carroll Public Library*.

"Plan to Unify City Cemetery Tracts Sought." *Carroll Daily Herald*, 9 Dec. 1933, *The Newspaper Archives of Carroll Public Library*.

Potter, Elisabeth Walton, and Beth M. Boland. *National Register Bulletin 41: Guidelines for Evaluating and Registering Cemeteries and Burial Places*, U.S. Department of Interior, National Park Service Interagency Resources Division, National Register of Historic Places, 1992, www.nps.gov/subjects/nationalregister/upload/NRB41-complete.pdf. Accessed 4 December 2020.

Reineke, David. "The German Heritage of Carroll County, Iowa." *Carroll County IAGenWeb History Journal*, 2020, Chapter 3, iagenweb.org/carroll/history/heritage/cntndx.htm. Accessed 3 Jan. 2020.

Schwieder, Dorothy. *Iowa: The Middle Land*. Iowa State University Press, 1996.

"Signet Lodge Installs Officers." *Carroll Daily Times Herald*, 15 Jan. 1970, *The Newspaper Archives of Carroll Public Library*.

Sloane, David Charles. *The Last Great Necessity: Cemeteries in American History*. The Johns Hopkins University Press, 1991.

Carroll City-Mount Olivet Cemetery

Carroll, Iowa

Name of Property

County and State

Spieker, Fred. *Title Deed*. Assessor's Office, Carroll County Courthouse, Carroll, IA. 16 Aug. 1927.

“Stone Fence Around Cemetery Completed For Memorial Day.” *Carroll Daily Herald*, 29 May 1937, *The Newspaper Archives of Carroll Public Library*.

“This is the gateway of the new WPA-built stone fence which flanks one side of the Carroll Cemetery.” *Carroll Daily Herald*, 1 June 1937, *The Newspaper Archives of Carroll Public Library*.

“Traner Installed As Maurice Dunn Legion Post Commander.” *Carroll Daily Herald*, 10 Nov. 1937, *The Newspaper Archives of Carroll Public Library*.

Tweed et al. “National Park Service Rustic Architecture: 1916-1942.” National Park Service Western Regional Office Division of Cultural Resource Management, February, 1977.
npshistory.com/publications/rustic-architecture.pdf. Accessed 14 Apr. 2021.

United States, Works Progress Administration, p. 17734.

---, ---, p. 17736.

---, ---, p. 17737.

“Will Begin Work On \$21,000 Relief Job At Cemetery Monday.” *Carroll Daily Herald*, 7 Dec. 1935, *The Newspaper Archives of Carroll Public Library*.

“Work In Full Swing On \$21,000 Carroll Cemetery Improvement.” *Carroll Daily Herald*, 11 Dec. 1935, *The Newspaper Archives of Carroll Public Library*.

Wyrick, Ray Floyd, Plan for Addition to City Cemetery Carroll, Iowa, 1933, Carroll City Cemetery.

Carroll City-Mount Olivet Cemetery
Name of Property

Carroll, Iowa
County and State

Previous documentation on file (NPS):

- preliminary determination of individual listing (36 CFR 67) has been requested
- previously listed in the National Register
- previously determined eligible by the National Register
- designated a National Historic Landmark
- recorded by Historic American Buildings Survey # _____
- recorded by Historic American Engineering Record # _____
- recorded by Historic American Landscape Survey # _____

Primary location of additional data:

- State Historic Preservation Office
- Other State Agency
- Federal Agency
- Local Government
- University
- Other
- Name of repository: _____

Historic Resources Survey Number (if assigned): _____

10. Geographical Data

Acreeage of Property 32.2 acres

(Do not include previously listed resource acreage; enter "Less than one" if the acreage is .99 or less)

Latitude/Longitude Coordinates

Datum if other than WGS84: _____
(enter coordinates to 6 decimal places)

1	<u>42.058681°</u> Latitude	<u>-94.861770°</u> Longitude	5	<u>42.054207°</u> Latitude	<u>-94.862534°</u> Longitude
2	<u>42.058685</u> Latitude	<u>-94.859329°</u> Longitude	6	<u>42.054218°</u> Latitude	<u>-94.862061°</u> Longitude
3	<u>42.053201°</u> Latitude	<u>-94.859326°</u> Longitude	7	<u>42.054418°</u> Latitude	<u>-94.862060°</u> Longitude
4	<u>42.053207°</u> Latitude	<u>-94.862535°</u> Longitude	8	<u>42.054420°</u> Latitude	<u>-94.861742°</u> Longitude

Carroll City-Mount Olivet Cemetery
Name of Property

Carroll, Iowa
County and State

Verbal Boundary Description (Describe the boundaries of the property.)

The boundary of the Carroll City-Mount Olivet Cemetery Historic District is bounded by South Grant Road on the east, East First Street on the north, behind residential neighborhoods along South Walnut Street and South Elm Street on the west, and (the reserve ground) on the south by Clark Street.

Boundary Justification (Explain why the boundaries were selected.)

The Carroll City-Mount Olivet Cemetery Historic District is the current boundary of the cemetery and encompasses the original plat of the Carroll City Cemetery and St. Joseph and Sts. Peter and Paul Catholic Cemeteries (now Mount Olivet Cemetery of the City of Carroll), as well as the 1933 Ries Addition between these and the 1927 two-acre addition to Sts. Peter and Paul Catholic Cemetery.

11. Form Prepared By

name/title Mary V. Gach and Carolyn Siemann date 1/5/2022
organization Carroll Historic Preservation Commission telephone _____
street & number _____ email mvghome@q.com, carolynsiemann@gmail.com
city or town Carroll state IA zip code 51401

Additional Documentation

Submit the following items with the completed form:

- **GIS Location Map (Google Earth or BING)**
- **Local Location Map**
- **Site Plan**
- **Floor Plans (As Applicable)**
- **Photo Location Map** (Key all photographs to this map and insert immediately after the photo log and before the list of figures).

Carroll City-Mount Olivet Cemetery
 Name of Property

Carroll, Iowa
 County and State

Photographs:

Submit clear and descriptive photographs under separate cover. The size of each image must be 3000x2000 pixels, at 300 ppi (pixels per inch) or larger. Key all photographs to the sketch map. Each photograph must be numbered and that number must correspond to the photograph number on the photo log. For simplicity, the name of the photographer, photo date, etc. may be listed once on the photograph log and does not need to be labeled on every photograph.

Photo Log

Name of Property: Carroll City- Mount Olivet Cemetery

City or Vicinity: Carroll

County: Carroll **State:** IA

Photographer: Mary V. Gach

Date Photographed: 2017 – 2020 (current photos)

Description of Photograph(s) and number, include description of view indicating direction of camera:

FIGURE	NAME	DATE TAKEN	LOOKING
Photo 4	Anneberg Mausoleum	Sep. 12, 2017	W
Photo 5	Amphitheater and rostrum	Aug. 27, 2020	NE
Photo 6	Civil War in Memorial Circle	Aug 27, 2020	SW
Photo 7	North gate	Aug. 24, 2020	N
Photo 8	North fence	Aug. 24, 2020	NE
Photo 9	2018 exterior museum	May 7, 2018	NW
Photo 10	2018 museum sw side	May 25, 2018	NE
Photo 11	Restroom south side	Sep. 3, 2020	N
Photo 12	Restroom west side	Aug. 23, 2020	E
Photo 13	Garage	Aug. 24, 2020	NE
Photo 14	East gateway and fence	Aug. 24, 2020	SW
Photo 15	Baby Land exedra	Sep. 4, 2020	W
Photo 16	American Legion from east	Aug. 30, 2020	W
Photo 17	American Legion from west	Aug. 30, 2020	E
Photo 18	Catholic Cemetery fence	Aug. 27, 2020	N
Photo 19	Catholic Cemetery gates	Sep. 26, 2020	E
Photo 20	Crucifixion Statues	Aug. 27, 2020	N
Photo 21	POW-MIA War Memorial	Aug. 27, 2020	NE
Photo 22	Veterans Memorial walkway	Aug. 27, 2020	S

Carroll City-Mount Olivet Cemetery

Carroll, Iowa

Name of Property

County and State

Figure 1 - Regional map, Google Earth 2019

Figure 2 - Carroll City-Mount Olivet Cemetery, Google Earth 2019

Figure 3 - Sketch map showing location of major features, buildings, structures, and objects within the Carroll City-Mount Olivet Cemetery. Map from Carroll City Hall, Carroll, IA

Figure 23 - Original City Cemetery site. Map from Carroll City Cemetery 2020

Figure 24 - Ries Addition site. Map from Carroll City Cemetery 2020

Figure 25 - Catholic Cemetery site. Map from Carroll City Cemetery 2020

Figure 26 - Plat of ten-acre Ries Addition in the Carroll City Cemetery, designed by Ray F. Wyrick.
Plat map from Carroll City Cemetery office

Figure 31 - Plat of Blocks 1 and 2 of the original City Cemetery, Carroll, IA, by William S. Winnett, 1872.
Plat map from Carroll County Courthouse, Carroll, IA

Figure 32 - Plat of the north Blocks 3 and 4 in the Original City Cemetery of Carroll, IA, by A. Bruch, 1885.
Plat map from Carroll County Courthouse, Carroll, IA

Figure 34 - Photographs location map. Map from Carroll City Hall, Carroll, IA

Figure 35 - Topographic map showing location of Carroll Cemetery (red outline) in the City of Carroll, Carroll County, IA. Source: USGS Carroll East Quadrangle Map, 7.5' Series, 2018

Figure 36 - Iowa map showing location of Carroll County, IA
600px-Map_of_Iowa_highlighting_Carroll_County.svg.png

